



Brake service equipment and tools 2007

WK 3



- 1 Test and inspection equipment**
- 2 Bleeding equipment**
- 3 Disposal equipment**
- 4 Special tools for brakes**
- 5 Bleeding unit adapters**
- 6 Spare part lists**

Continental Teves AG & Co. oHG reserves all rights, including complete or partial reproduction and any form of duplication, translation and transmission. Specifications and design are subject to change without prior notice. No claims relating to the specifications appearing in this catalog will be accepted.





ATE EST-All-purpose service tool

Order no.: 03.9301-1000.4

Short order no.: 760139

In state-of-the-art cars, many service jobs, for example brake servicing, today no longer can be performed without the use of a diagnosis system. To be able to carry out such work you need the vehicle manufacturer's diagnosis system or alternative equipment designed to do the same task.

Now there is an all-purpose solution that makes many of these individual devices unnecessary: the ATE EST.

The ATE EST can be configured for the task at hand, for example various jobs on the brake system, by loading software modules.

You don't need a lengthy set of instructions to use the ATE EST, the simple operation plus detailed work instructions provided on a display enable you to work intuitively.

As the software modules are adapted to specific tasks, the possibility of operating errors is minimized – highly reliable operation is ensured.

You can load or update the software modules yourself with the help of your computer in 3 easy steps:

1. Connect ATE EST with a PC (via USB cable).
2. Select software module for the particular application.
3. Load ATE EST software module – and you're ready!

Benefits:

- One single device for several applications
- Through software modules applicable for:
 - SBC (CAN + K-Line) deactivate and activate plus bleeding
 - EPB - electric parking brake open and close plus basic setting
 - Other software modules will be ready for market in 2007
- Updates through USB interface
- Easy user guidance

Scope of supply:

- basic unit
- 1 software module
- OBD cable
- USB cable
- Flash software CD
- Manual CD
- Robust case



2nd generation AST sensor tester

Order no.: 03.9301-0110.4

Short order no.: 760132

The ATE 2nd generation AST sensor tester is used for testing virtually all ABS wheel sensors, the ATE ESP sensors (in conjunction with the ESP testing set 03.9301-0113.2 / 760137) and other ABS sensors. During diagnosis of the active and passive wheel speed sensors and their sensor wheels, the ATE AST sensor tester automatically recognizes which type of sensor is being diagnosed. The function of the sensors - the sensor signal - as well as the "number of teeth" of the pulse-generating wheel are checked and displayed. The ESP testing set (03.9301-0113.2 / 760137) allows the ATE ESP sensors (yaw rate, acceleration, pressure) to be tested. It is also possible to test other sensors if the rated values are known. Users are guided through the testing process step-by-step, so they need no operating instructions when working on site. A universal connection adapter is included so that the unit can be connected to the various wheel sensors. For the power supply (12 Volt), two adapters are included, one for the cigarette lighter and one for the battery. Its state-of-the-art flash technology make the ATE AST sensor tester updatable and thus perfectly prepared for the future.



Benefits:

- Simple to use, reliable
- Inexpensive diagnosis option

Scope of supply:

- Complete unit
- Set of test cables with pincer clips
- Power supply adapter for cigarette lighter
- Power supply adapter for battery
- Operating instructions
- Robust case

Technical data:

Dimensions: H x W x D	217 x 113 x 38 mm
Voltage requirements:	9 - 16 Volt DC
Power consumption:	170 mA

ESP testing set

Order no.: 03.9301-0113.2

Short order no.: 760137

The ATE ESP testing set is an accessory for the ATE 2nd generation AST sensor tester. The ATE ESP testing set extends the range of application of the ATE AST sensor tester by providing the possibility of testing ATE ESP sensors (yaw rate, acceleration and pressure sensors).

Scope of supply:

- 3 testing cables
- 1 pincer clip



Test card for magnetic sensor wheels

Order no.: 03.9301-0200.1

Short order no.: 760130

The new active wheel speed sensors work with magnetic sensor wheels, which are integrated in the rubber sealing ring of the wheel bearing. For this, the rubber is enriched with iron dust and then given magnetic fields which are highly sensitive.

It is not possible to check the magnetic sensor wheels visually. Before a new wheel bearing is installed, it is therefore absolutely necessary that the wheels be checked. The part could be faulty, and the direction of installation must be determined. But when checking errors in the ABS it may also be necessary in the case of sensor errors to check the magnetic sensor wheels.

With the ATE test card for magnetic sensor wheels, these tests can be carried out reliably, easily and inexpensively. The magnetic fields of the sensor wheel are shown visually in the display window of the ATE test card, making it possible to check them.

The ATE test card for magnetic sensor wheels comes with an integrated protective case.



Benefits:

Fast, simple and inexpensive.

Scope of supply:

Test card with integrated protective case, with brief operating instructions.

Circuit diagram CD

Order no.: 03.9301-0300.1

Short order no.: 760131

The ATE circuit diagram CD contains the information required for the diagnosis of ABS, EDL, TCS, and ESC (major brands) for approximately 2,300 vehicle types.

Scope of supply:

- One CD

Work flow:

- Selection of vehicle manufacturer, vehicle type and engine version
- Selection of the ABS system by designation or illustration
- Display or printout of:
 - the circuit diagram or
 - the components or
 - the terminal assignment or
 - the list of error codes
- quick test list

Note:

System requirements:

- Windows 98/mE, WindowsNT 4.0, Windows 98, Windows XP.
- Pentium 166 MHz or comparable PC.
- 32 MB RAM.
- CD-ROM, at least 16x speed.
- 800 x 600, 65,000 colors (HiColor)



SBS

Order no.: 03.9301-0400.4

Short order no.: 760129

The electrohydraulic brake system (SBC) on Mercedes Benz vehicles W211 (E class) and R 230 (SL) is under a pressure of approx. 140 bar. Under certain circumstances, the wheel brake may be pressurized automatically, even if the ignition key is withdrawn. This means that there is a risk of injury to the service engineer during repair work and the brake system may be damaged.

The ATE SBS allows the electrohydraulic brake system (SBC) to be deactivated and the pressure to be released simply and safely prior to service or repair work. Once work is completed, the SBC is reactivated using the ATE SBS and the system pressure is established again.

Benefits:

Safe, easily used, inexpensive solution for workshops.

Scope of supply:

- Device
- Operating instructions

Approval mark:

CE

Work flow:

The ATE SBS is plugged into the OBD socket.

Prior to repair work etc. the SBC is deactivated using the red button, thus releasing the system pressure.

It is now safe to carry out the necessary work.

Once the work has been completed, the SBC is reactivated using the green button and the system pressure is established again. Stored error codes are automatically deleted in the process.

Safety note:

- The vehicle must not be driven while the ATE SBS is still connected.
- The vehicle must only be driven once the activation procedure has been completed successfully.

Technical data:

Dimensions H x W x D	97 x 47 x 26 mm
Weight	0.06 kg



Brake fluid test unit BFT 320

Order no.: 03.9311-0080.4

Short order no.: 730071

Brake fluid is hygroscopic, which means that it absorbs water over the course of time, thus causing the boiling point to drop (risk of vapor lock). That is why it needs to be checked regularly and, if necessary, replaced.

The particularly inexpensive ATE BFT 320 allows measurement of the boiling points of all glycol-based brake fluids (DOT 3, DOT 4, DOT 5.1) with the same precision as in a laboratory.

The ATE BFT 320 is an extremely practical tester with a 12-Volt power supply.

This means that it is simple to perform the measurement at the expansion tank in the vehicle. A specimen vial and a pipette are supplied to allow measurements to be performed away from the vehicle.

The simple menu guidance for users is a highlight of the ATE BFT 320. Measurement takes only around 30 seconds and the measured value is shown on a digital display. A recommendation as to whether to replace the brake fluid is then shown.

This means that it is no longer necessary to change brake fluid merely on suspicion.

Benefits:

- The immersion heater method is the only one that provides exact measurements, regardless of the brake fluid type
- Menu guidance makes it extremely simple to use
- Digital display of the boiling point and recommendation as to whether to change the brake fluid
- Practical tester, measurement can be performed in the expansion tank
- 12 Volt power supply
- Suitable for brake fluids with boiling points up to 320 °C

Scope of supply:

- Complete test unit
- Specimen vial and pipette
- Operating instructions
- Robust case

Technical data:

Accuracy:

at 100-180° C: +/- 3%

> 180° C: +/- 5%

Measuring time: approx. 30 seconds

Power supply: 12 Volt



Brake fluid test equipment BFCS 300

Order no.: 03.9311-0070.4

Short order no.: 730060

Brake fluid is hygroscopic, which means that it absorbs water over the course of time, thus causing the boiling point to drop (vapor lock). That is why it needs to be checked regularly and, if necessary, replaced. The ATE BFCS 300 allows rapid measurement of the in-service boiling points of all glycol-based brake fluids (DOT 3, DOT 4, DOT 5.1) with the same precision as in a laboratory. This is done by taking a sample (10 ml) with a disposable pipette (ATE sampling set) transferring it to a disposable specimen vial (ATE sampling set) and bringing it to boiling point in the ATE BFCS (immersion heater method). Measurement takes only around 20 seconds and the measured value is shown on a digital display. This means that it is no longer necessary to change brake fluid merely on suspicion. The number of measurements carried out is can be determined using an integrated short-term and long-term counter.



Benefits:

- The immersion heater method is the only one that provides exact measurements, regardless of the brake fluid type
- Extremely easy to use
- Suitable for brake fluids with boiling points up to 300 °C

Scope of supply:

- Unit
- 1 disposable pipette
- 1 disposable specimen vial
- Operating instructions

Approval mark:

CE

Spare parts:

The sensor head with heating coil (03.9311-0072.1/730061) is replaceable.

Note:

Never use the equipment without a specimen.

Technical data:

Accuracy:	
at 150-200 °C	+/- 4 to +/- 6 °C
at 200-280 °C	+/- 7 to +/- 9.5 °C
at 280-300 °C	+/- 10 to +/- 15 °C
Measuring time:	15 to 35 seconds
Power consumption:	during measurement 170 VA
	on standby 33 VA
Dimensions: H x W x D	180 x 225 x 225 mm
Weight:	5.4 kg

Sensor head

Order no.: 03.9311-0072.1

Short order no.: 730061

If the ATE BFCS 300 is no longer able to bring the brake fluid sample to boiling point, the reason is often that the heating coil is damaged. This is located in the sensor head and can easily be replaced.

Work flow:

Prior to any work on the unit, disconnect the unit from the electric power supply. Remove the sensor head carefully in a downward direction, and do not twist it. Align the new sensor head as indicated by the two arrow markings, and, without twisting it, push it into its mounting. The sensor head clicks into place. Now test that the unit operates correctly, preferably with new brake fluid.



Sampling set

Order no.: 03.9311-0019.2

Short order no.: 730066

The disposable pipette is used to extract the brake fluid being tested from the vehicle and fill it into the disposable specimen vial so that the boiling point can be determined with the ATE BFCS 300.

Scope of supply:

50 disposable pipettes
50 disposable specimen vials

Note:

Every time a measurement is taken, it is recommended that both a new pipette and a new specimen vial are used, so as to avoid falsifying the results.



Pressure gauge unit

Order no.: 03.9305-1020.4
Short order no.: 730032

The ATE pressure gauge unit is extremely versatile. It allows measurement of all pressures throughout the hydraulic brake system and in the vacuum system (brake power assist unit etc.) Thanks to two measuring circuits with high-pressure manometers, the pressure in both brake circuits can be measured simultaneously, allowing simple comparison. This is the only way to check or adjust the regulators.

One of the measuring circuits also has a low-pressure manometer that is switched off at approx. 9.5 bar. This allows both low-pressure and high-pressure leakage tests to be carried out. The unit is connected to the hydraulic system by means of an adapter instead of bleeder valves as well as plug-and-socket connectors and low-stretch mini-hoses. Suitable adapters for connection to the test connectors are also supplied with the unit.

The vacuum manometer allows the vacuum system to be tested for leaks and correct operation. Suitable adapters for connecting the unit are also supplied.

All accessories are stored in appropriate holders inside the unit.



Benefits:

- Robust construction
- Measurement of directly applied pressure / vacuum
- The use of mini-hoses avoids hose stretching, thus providing high measuring accuracy
- Connection fittings are also supplied and are stored in the unit

Scope of supply:

- Unit complete with connecting hoses
- 2 sets of connection nipples (7 items M 6 to M 12 x 1.5)
- 2 test connection adapters
- 2 plug-on nipples (male)
- 4 vacuum connecting sleeves
- 1 elbow connection complete (banjo screw, ring support)
- Operating instructions

Approval mark:

CE

Note:

Unit is supplied uncalibrated, but can be calibrated subsequently.

Technical data:

Low-pressure measuring range	0 to 9.5 bar
High-pressure measuring range	0 to 250 bar
Vacuum measuring range	0 to -1.0 bar
Automatic cutoff of the low-pressure manometer at	approx. 9.5 bar
Length of connecting hose:	3.0 m
Length of vacuum hose:	2.0 m
Dimensions: H x W x D	420 x 350 x 220 mm
Weight:	10 kg

Pressure gauge

Order no.: 03.9305-0200.4

Short order no.: 730029

The ATE pressure gauge allows all pressures to be measured in one brake circuit of the hydraulic brake system. The measuring circuit consists of a high-pressure and low-pressure manometer that cuts off automatically at approx. 9.5 bar. This allows both low-pressure and high-pressure leakage tests to be carried out. The unit is connected to the hydraulic system by means of an adapter instead of bleeder valves as well as plug-and-socket connectors and low-stretch mini-hoses. All accessories are stored in the unit in suitable holders.

Benefits:

- Robust construction
- Measurement of directly applied hydraulic pressure
- The use of mini-hoses avoids hose stretching, thus providing high measuring accuracy
- Connection fittings are also supplied with the unit

Scope of supply:

- Unit complete with connection hose
- 1 coupling head
- 7 connector nipples (M 6 to M 12x 1.5)
- Operation instructions

Note:

Unit is supplied uncalibrated, but can be calibrated subsequently.

Technical data:

Low-pressure measurement range	0 to 9.5 bar
High-pressure measurement range	0 to 250 bar
Automatic shutoff of the low-pressure manometer at	approx. 9.5 bar
Length of connecting cable:	1.5 m
Dimensions: H x W x D	320 x 230 x 160 mm
Weight:	5.5 kg



Extension hose

Order no.: 03.9305-1042.2

Short order no.: 730043

With the ATE extension hoses, each of the connecting hoses on the pressure gauge unit (3.9305-1020.4 / 730032) can be lengthened by 5 meters.

Benefits:

If 2 extension hoses are used on the pressure-gauge unit, a total hose length of 16.0 m can be achieved.

Technical data:

Length:	5.0 m
---------	-------



Pedal arrester

Order no.: 03.9312-0100.4

Short order no.: 760032

When carrying out leakage checks on the hydraulic brake system it is necessary to maintain a constant brake-pedal pressure over a long period. Constant brake-pedal pressure is also needed to check and adjust brake-pressure regulators or limiters. The ATE pedal arrester is ideal for this purpose.

The soft support plate is placed against the driver's seat and the serrated side against the brake pedal. The required pressure can be set using the handwheel, that operates on a toothed rack. A catch locks the unit at the required value.

Benefits:

The required pressure can be set precisely with the handwheel and toothed rack.



Digital brake disk caliper gauge

Order no.: 03.9314-0010.3

Short order no.: 760138

The digital ATE brake disk caliper gauge is an indispensable tool for precisely determining brake disk wear. It enables quick and easy measurement of brake disk thickness, i.e., the degree of wear. The measuring range is 125 mm and the length of the measuring jaws is 85 mm. The design of the measuring jaws permits exact measurement even if the disc has a ridge.

Work with the digital ATE brake disc caliper gauge couldn't be easier. After the measuring jaws have been positioned on the brake disk, the result of measurement is shown in figures on the display. The reading is saved by briefly pressing the hold button. The caliper gauge then can be opened and removed from the brake disk. The reading remains saved until the hold button is pressed again. This is a big advantage especially if accessibility is a problem or poor lighting conditions in the wheel well impede reading. The result of measurement thus can be conveniently read and compared with the desired value.

If required, null balancing of the gauge can be quickly initiated at the push of a button. The user can freely choose between "mm" and "inch" as units of measure.

The big advantage of the digital ATE brake disk caliper gauge is that no special know-how is required for taking readings. The digital reading display is self-explanatory even to laypersons and can be nicely used for sales talks with the customer.

The digital ATE brake disk caliper gauge is an indispensable tool for precisely determining brake disk wear. It enables quick and easy measurement of brake disk thickness, i.e., the degree of wear. The measuring range is 125 mm and the length of the measuring jaws is 85 mm. The design of the measuring jaws permits exact measurement even if the disc has a ridge.

Work with the digital ATE brake disc caliper gauge couldn't be easier. After the measuring jaws have been positioned on the brake disk, the result of measurement is shown in figures on the display. The reading is saved by briefly pressing the hold button. The caliper gauge then can be opened and removed from the brake disk. The reading remains saved until the hold button is pressed again. This is a big advantage especially if accessibility is a problem or poor lighting conditions in the wheel well impede reading. The result of measurement thus can be conveniently read and compared with the desired value.

If required, null balancing of the gauge can be quickly initiated at the push of a button. The user can freely choose between "mm" and "inch" as units of measure.

The big advantage of the digital ATE brake disk caliper gauge is that no special know-how is required for taking readings. The digital reading display is self-explanatory even to laypersons and can be nicely used for sales talks with the customer.

Benefits:

- Convenient, reliable reading of measurements
- Easy saving of readings
- Measuring jaw design permits accurate measurement even if a brake disk has a ridge
- Sturdy design suited for workshop use

Scope of supply:

- Complete instrument in sturdy plastic box
- Substitute battery
- Operating instructions



Straight edge

Order no.: 03.9314-0022.1

Short order no.: 760094

Before a brake disk is mounted, the wheel hub should be checked for flatness (distortion). This is easily done with the ATE straight edge, and the light gap method. Its length of 200 mm allows even larger surfaces to be easily checked.



Dial gauge with large measuring range

Order no.: 03.9304-0034.2

Short order no.: 760093

The ATE dial gauge with 1/100 mm reading accuracy is used to measure brake disks and wheel hubs. If measurement is to be carried out in situ on the vehicle, an ATE dial-gauge holder is required. The 8 mm clamping shaft diameter of the ATE dial gauge is standardized. The long probe allows measurement of a wheel hub despite wheel studs. The special exchangeable ball-shaped probe allows easy measurement of brake disks such as the ATE Power Disc. The knurled, rotatable outer ring with 360° tick scale allows pointer zero adjustment and makes the ATE dial gauge easy to read. Two adjustable tolerance marks make it easy to take an accurate reading.

Benefits:

- Wheel hub can be measured despite wheel studs
- With exchangeable ball-shaped probe

Scope of supply:

- Dial gauge with probe
- Special ball-shaped probe



Magnetic dial-gauge holder

Order no.: 03.9314-0019.2

Short order no.: 760092

The ATE magnetic dial-gauge holder, used in conjunction with the ATE dial gauge, enables lateral and radial run-out measurements to be taken on brake disks and wheel hubs. Its 70 movable steel pins provide a perfect fit on uneven surfaces. This means that the 60 N strong magnet adheres optimally. The three swivel arms can be secured by means of a clamping screw and allow the ATE dial gauge to be aligned with any measuring point. A fine adjustment mechanism at the clamp of the dial-gauge permits precise zero point calibration of the ATE dial gauge.

Benefits:

- 70 flexible steel segments adapt perfectly to any shape surface
- Constant securing force of 60 N
- One clamping screw fixes all three swivel arms at the same time
- Fine tuning via a knurled screw

Scope of supply:

Supplied without dial gauge



Dial-gauge holder

Order no.: 03.9314-5500.3

Short order no.: 760062

The ATE dial-gauge holder, used in combination with the ATE dial gauge, enables lateral and radial run-out measurements to be made on brake disks and wheel hubs. Its clamping arms allow it to be secured in fixed calipers or in the mountings of floating calipers.

Scope of supply:

Supplied without dial gauge



Brake disk measurement equipment

Order no.: 03.9304-0100.4

Short order no.: 730072

The ATE brake disk measurement equipment allows precise measurement of the lateral run-out and thickness tolerance of brake disks which have been removed from the vehicle (without bearing seat). Brake disks of diameters up to 360 mm can be measured. Precise measurement of the brake disk is ensured by the no-play bearing and the polished contact surface of the support cups. The brake disk to be measured is centered precisely using a cone. The exchangeable support cups mean that there is a small support area available for measuring small brake disks. A dial gauge (with a 0.1 mm scale) is included with the unit. When combined with the ball-shaped probe, measurements can be carried out on all types of brake disks (e.g. ATE Power Disc).



Benefits:

- Extremely simple to use
- Lateral run-out and thickness measured with one tool
- Measurements read on a single dial gauge

Scope of supply:

- Complete brake disk measurement equipment with large and small support cup
- Dial gauge with probe
- Ball-shaped probe
- Operating instructions

Technical data:

Accuracy:	1/100 mm
Dimensions: L x W x H	300 x 170 x 230 mm
Weight:	6.85 kg



5-liter pneumatically operated brake bleeding unit FB 5p

Order no.: 03.9302-1350.4

Short order no.: 740230

The new ATE FB 5p is a pneumatically operated bleeding unit for 5 liters of brake fluid and represents a low-cost alternative to the ATE electrical bleeding units. With the wide range of ATE accessories, all hydraulic clutch and brake systems - including ABS, EDS or ESP - can be filled, flushed and bled. A low-pressure leakage test of a brake or clutch system can also be easily carried out. Only one person is needed to operate the ATE FB 5p.

A particular advantage of the ATE FB 5p is that, once it has been topped up with compressed air, it can be used anywhere, so it is ideal for "off-premises" work.

The ATE FB 5p works according to the principle of medium separation, i.e. the brake fluid is separated from the compressed air by a diaphragm, so that air can never enter the brake system. One single filling of compressed air is sufficient to drain 5 liters of brake fluid. The working pressure (the pressure with which the new brake fluid is fed into the brake system) is adjustable and can be seen on the working-pressure manometer. At 3.5 meters, the length of the filling hose is sufficient for all requirements.

It goes without saying that all materials used on the FB 5p are completely resistant to brake fluid.



Benefits:

- Low-cost alternative
- Once topped up, the unit is mobile and can be used anywhere

Scope of supply:

- Unit complete
- Operating instructions

Technical data:

Brake fluid capacity:	5 liters
Working pressure (compressed air):	6.5 bar
Operating pressure (brake fluid):	2 bar (0 to 3 bar adjustable)
Filling hose length:	3.5 m
Total height:	510 mm
Diameter:	310 mm
Weight:	10 kg

15 liter electrical brake bleeding unit - FB 15

Order no.: 03.9302-1650.4

Short order no.: 740229

The new ATE FB 15 is an electrically operated bleeder with a capacity of 15 liters of brake fluid. It has a particularly robust construction. With the wide range of ATE accessories, all hydraulic clutch and brake systems - including ABS, EDS or ESP - can be filled, flushed and bled. The pump of the ATE FB 15 is sufficiently powerful to be used on truck transmission control systems. A low-pressure leakage test of a brake or clutch system can be easily carried out with the ATE FB 15. Only one person is needed to operate the ATE FB 15.

Its large casters and the convenient steering handle allow it to be moved easily. Practical holders are provided on the unit for the filling hose, the power cable and for four ATE bleeding unit adapters. The clearly-arranged control elements make the ATE FB 15 easy to operate. The fluid-level indicator allows you to check the amount remaining in the brake fluid tank. If it is necessary to top up the brake fluid, this can be done while the unit is running, because the ATE FB15 does not need to be bled again. If there is insufficient brake fluid in the unit, the pump is automatically switched off, a clear warning signal sounds, and no air can be drawn in. The working pressure can be adjusted by a pressure regulator that is protected against inadvertent adjustment and can be monitored with the working-pressure manometer. At 3.5 meters, the length of the filling hose is sufficient for all requirements.

It goes without saying that all materials used on the FB 15 are completely resistant to brake fluid.



Benefits:

- Well-proven, particularly robust unit for workshop use

Scope of supply:

- Unit complete
- Operating instructions

Approval mark:

CE

Technical data:

Brake fluid capacity:	15 liters
Power supply:	230 V ~ , 50-60 Hz
Delivery rate of pump:	1.3 l/min
Working pressure:	2 bar (0 to 3 bar adjustable)
Automatic cut-off of pump:	at approx. 9 mm remaining fluid level
Length of connecting cable:	4.20m
Filling hose length:	3.5 m
Dimensions: H x W x D :	745 x 380 x 705 mm
Weight:	20.5 kg

15 liter electrical brake bleeding unit FB 15 for mineral oil

Order no.: 03.9302-1660.4

Short order no.: 740231

The new ATE FB 15 in the version for use with mineral oil is an electrically operated bleeding unit with a tank capacity of 15 liters. It has a particularly robust construction. The powerful pump allows all hydraulic clutch and brake systems, including ABS, EDS or ESP, can be filled, flushed and bled and also permits use on transmission control systems and other hydraulic systems. A low-pressure leakage test of a brake or clutch system can be easily carried out with the ATE FB 15. An ATE accessory set is available for the mineral oil version of the ATE FB 15. Only one person is needed to operate the ATE FB 15. Its large casters and the convenient steering handle allow it to be moved easily. Practical holders are provided on the unit for the filling hose, the power cable and for four ATE bleeding unit adapters. The clearly-arranged control elements make the ATE FB 15 easy to operate. The fluid-level indicator allows you to check the amount remaining in the brake fluid tank. If it is necessary to top up the brake fluid, this can be done while the unit is running, because the ATE FB15 does not need to be bled again. If there is insufficient brake fluid in the unit, the pump is automatically switched off, a clear warning signal sounds, and no air can be drawn in. The working pressure can be adjusted by a pressure regulator that is protected against inadvertent adjustment and can be monitored with the working-pressure manometer. At 3.5 meters, the length of the filling hose is sufficient for all requirements. It goes without saying that all materials used on the FB 15 are completely resistant to mineral oil.

Benefits:

- Well-proven, particularly robust unit for workshop use

Scope of supply:

- Unit complete
- Adapters for connecting the unit must be ordered separately
- Operating instructions

Approval mark:

CE

Type:

For mineral oil

Technical data:

Brake fluid capacity:	15 liters
Power supply:	230V ~ , 50-60 Hz
Delivery rate of pump:	1.3 l/min
Working pressure:	2 bar (0 to 3 bar adjustable)
Automatic cut-off of pump:	at approx. 9 mm remaining fluid level
Length of connecting cable:	4.20m
Filling hose length:	3.5 m
Dimensions: H x W x D :	745 x 380 x 705 mm
Weight:	20.5 kg



30-liter electric brake bleeding unit FB 30 EDR

Order no.: 03.9302-3000.4

Short order no.: 740273

The ATE FB 30 EDR is an electrically operated bleeding unit using ATE brake fluid cans of 5, 12, 20 or 30 liters capacity. The cans are mounted directly in the unit. The wide range of ATE accessories makes it possible to fill, flush and bleed all hydraulic clutch and brake systems including ABS, EDS, ESP and SBC.

The ATE FB 30 EDR is fitted with an electronic pressure control facility (EDR) with preset pressure levels of 0.4 bar, 1.0 bar and 2.2 bar (suitable for all applications). The selected pressure is maintained at a constant level under all operating conditions by the electronic control system, this can be checked with the integrated manometer.

The brake fluid level in the can is monitored by a float switch. If the level falls too low, the float switch switches off the pump and a clear acoustic signal is sounded. This means that no air is drawn in and the user is informed when the can is empty.

The ATE FB 30 EDR also allows modern, low-viscosity brake fluids to be used (in particular ESP brake fluids). All the operating and monitoring controls are clearly and ergonomically arranged on the tilted front panel of the unit.

To allow it to be moved easily, the ATE FB 30 EDR has large wheels and a convenient steering handle. Holders for the filling hose and power cable are provided on the sides of the unit.

The ATE FB 30 EDR also features a practical storage tray for small components.

It goes without saying that all materials used on the FB 30 EDR are completely resistant to brake fluid.

The most up-to-date technology means that the ATE FB 30 EDR is ideally equipped for today's and tomorrow's fields of application.



Benefits:

- Brake fluid container can be used directly without being refilled
- Versatile, suitable for various container sizes / shapes from 5-30 liters
- Absolutely constant working pressure thanks to electronic pressure control (EDR)
- Automatic cut-off with acoustic warning if the can is empty
- Suitable for low-viscosity brake fluids

Scope of supply:

- Complete unit (without brake fluid cans)
- Adapters for connecting the unit must be ordered separately
- Operating instructions

Approval mark:

CE

Technical data:

Brake fluid capacity:	5 to 30 liters
Power supply:	230 V ~ , 50 - 60 Hz
Delivery rate of pump:	1.1 l/min
Electronic pressure control system (EDR), pressure levels:	0.4 bar, 1.0 bar and 2.2 bar
Automatic cut-off of pump:	at approx. 9 mm remaining fluid level in the can
Length of connecting cable:	4.2 m
Filling hose length:	3.5 m
Dimensions: H x W x D:	915 x 440 x 365 mm
Weight:	15.9 kg

Set of bleeding unit adapters (standard)

Order no.: 03.9302-0800.3

Short order no.: 740271

Set of five the most common standard bleeding unit adapters and an auxiliary hose in a handy plastic case.

Scope of supply:

Plastic case

Bleeding unit adapters :

no. 20 = 03.9302-0948.2 / 740280

no. 22+22/1 = 03.9302-0901.3 / 740094

no. 50S = 03.9302-0927.2 / 740120

no. 55A = 03.9302-0906.2 / 740097

Auxiliary hose:

no. 67 = 03.9302-0704.2 / 740012



Set of bleeding unit adapters for Asian vehicles

Order no.: 03.9302-0709.3

Short order no.: 740225

Set of six of the most common standard bleeding unit adapters for Asian vehicles and an auxiliary hose in a handy plastic case.

Scope of supply:

Plastic case

Bleeding unit adapters :

no. 37 = 03.9302-0736.2 / 740039

no. 41 = 03.9302-0786.2 / 740073

no. 43 = 03.9302-0774.2 / 740063

no. 49 = 03.9302-0746.2 / 740044

no. 55A = 03.9302-0906.2 / 740097

no. 77 = 03.9302-0914.2 / 740107

Auxiliary hose:

no. 67 = 03.9302-0704.2 / 740012



Mineral oil accessory set

Order no.: 03.9302-0720.3

Short order no.: 740232

The mineral oil accessory set is required for bleeding and filling systems with mineral oil using the bleeding unit 03.9302-1660.4. It has been specially designed to be completely resistant to mineral oil for this purpose. The bleeding unit adapter has a 45-mm diameter buttress thread.

The auxiliary hose allows the bleeding unit to be connected to one of the bleed valves in the system. The filling gun permits easy refilling without spillage. Spare seals for the bleeding unit adapter and the filling gun are included in the set.

Scope of supply:

- Bleeding unit adapter with 45-mm buttress thread
- Filling gun
- Auxiliary hose
- Spare seal for bleeding unit adapter
- Spare seal for auxiliary hose



Auxiliary hose

Order no.: 03.9302-0704.2
Short order no.: 740012

To connect the bleeding units to a bleed valve of the brake or clutch system



Filling gun

Order no.: 03.9302-0795.2
Short order no.: 740085

The filling gun is used to fill fluid reservoirs using a bleeding unit.

Benefits:

Easy-to-use lever for actuates the valve, allowing precise dosage of the fluid.



Collection bottle

Order no.: 03.9302-1424.2
Short order no.: 740151

The ATE collection bottle is connected to the bleeder valves of a hydraulic brake system via its silicon hose to collect the used brake fluid when the system is bled or the brake fluid is changed. The ATE collection is transparent, allowing the brake fluid to be checked thoroughly.



Bleed hose

Order no.: 03.9302-0538.1

Short order no.: 750008

The ATE bleed hose is a spare part for the ATE collection bottle 03.9302-1424.2 and the ATE collection container 03.9302-0516.2



Technical data:

length:	700 mm
---------	--------

Suction bellows

Order no.: 03.9314-5900.3

Short order no.: 760068

The ATE suction bellows is used to draw off brake fluid from the fluid reservoir.

Before the brake fluid is changed or a hydraulic brake system is bled, the old contaminated brake fluid should be drained from the fluid reservoir to prevent any contaminants being distributed throughout the entire brake system. After the brake fluid has been changed or the system has been bled, the brake fluid level should be reduced to the MAX mark using the suction bellows.



Suction bottle

Order no.: 03.9314-5910.3

Short order no.: 760069

The ATE suction bottle is used to draw off brake fluid from the fluid reservoir.

Before the brake fluid is changed or a hydraulic brake system is bled, the old contaminated brake fluid should be drained from the fluid reservoir to prevent any contaminants being distributed throughout the entire brake system. After the brake fluid has been changed or the system has been bled, the brake fluid level should be reduced to the MAX mark using the suction bottle.



Technical data:

Volume:	0.5 liters
---------	------------

Set of bleed wrenches

Order no.: 03.9314-1500.3

Short order no.: 760041

ATE bleeder wrenches can be used to open and close all common bleed valves easily and without damage thanks to the internal hexagon of the ring end that is angled by 10°.

Benefits:

Ring end is designed as an internal hexagon wrench.

Scope of supply:

6 wrenches in a case

Sizes: 7, 8, 9, 11, 12, 14 mm



Set of special bleed wrenches

Order no.: 03.9314-1510.3

Short order no.: 760103

The special ATE bleed wrenches are ring wrenches with an internal hexagonal head to prevent the damage of bleed valves. Thanks to a long offset and a short offset, they can be used without removing the wheel.

Benefits:

- Hexagonal head
- Can be used without removing the wheel

Scope of supply:

5 wrenches

Sizes: 7, 8, 9, 10, 11mm



Pouring spout

Order no.: 03.9314-5940.3

Short order no.: 760070

With the ATE pouring spout, the ATE bleeding units can be filled precisely and without spilling from 5, 12 and 20 liter ATE brake fluid cans.

Benefits:

There is no need for any other equipment, such as funnels etc.



Barrel outlet valve

Order no.: 03.9314-5950.3

Short order no.: 760071

The ATE barrel outlet valve allows brake fluid to be filled into the ATE bleeding units from ATE 30 and 60-liter barrels without spilling, using a 700 mm outlet hose.





Brake fluid disposal unit System 220

Order no.: 03.9302-0504.3

Short order no.: 750001

Used brake fluid is a recyclable material, provided it is collected properly segregated in a closed system. This can be achieved with the ATE System 220. Segregated used brake fluid is considerably less expensive to dispose of.

The ATE System 220 consists of the 4-liter collection container and the 220-liter storage container. The collection container is connected to the bleed valve with a long-life silicon hose. When it is full, it is connected to the 220-liter storage container to be drained with a quick-release coupling. When the 220-liter storage container is full, the segregated used brake fluid can be picked up by a local waste disposal specialist.

Benefits:

- Used brake fluid is an asset whose components can be recycled
- Reduction of disposal costs
- Protection of the environment

Scope of supply:

- 220-liter storage container
- 4-liter collection container



Brake fluid disposal unit System 222

Order no.: 03.9302-0506.3

Short order no.: 750002

Used brake fluid is a recyclable material, provided it is collected properly segregated in a closed system. This can be achieved with the ATE System 222. Segregated used brake fluid is considerably less expensive to dispose of.

The ATE System 222 consists of two 4-liter collection containers and the 220-liter storage container with two couplings. The collection container is connected to the bleed valve with a long-life silicon hose. When it is full, it is connected to the 220-liter storage container to be drained with a quick-release coupling. The 4-liter capacity of the collection container allows several changes of brake fluid or bleeding operations. When the 220-liter storage container is full, the segregated used brake fluid can be picked up by a local waste disposal specialist. Because two collection containers are available, it is possible to work on two vehicles at the same time.

Benefits:

- Used brake fluid is an asset whose components can be recycled
- Reduction of disposal costs
- Protection of the environment

Scope of supply:

- 220-liter storage container
- 2 collection containers, each holding 4 liters
- dual drainage connector



Brake fluid disposal unit System 224

Order no.: 03.9302-0508.3

Short order no.: 750003

Used brake fluid is a recyclable material, provided it is collected properly segregated in a closed system. This can be achieved with the ATE System 224. Segregated used brake fluid is considerably less expensive to dispose of.

The ATE System 224 consists of four 4-liter collection containers and the 220-liter storage container with four couplings. The collection container is connected to the bleed valve with a long-life silicon hose. When it is full, it is connected to the 220-liter storage container to be drained with a quick-release coupling. The 4-liter capacity of the collection container allows several changes of brake fluid or bleeding operations. When the 220-liter storage container is full, the segregated used brake fluid can be picked up by a local waste disposal specialist. Because four collection containers are available, it is possible to work on four vehicles at the same time.

Benefits:

- Used brake fluid is an asset whose components can be recycled
- Reduction of disposal costs
- Protection of the environment

Scope of supply:

- 220-liter storage container
- 4 collection containers, each holding 4 liters
- Quadruple drainage connector



Dual drainage connector

Order no.: 03.9302-0521.2

Short order no.: 750007

- Spare part for ATE brake fluid disposal system 222
- Upgrading a system 220 to two collection containers

Benefits:

2 collection containers can be connected to the 220 liter storage container at the same time and drained.



Quadruple drainage connector

Order no.: 03.9302-0520.2

Short order no.: 750006

- Spare part for ATE brake fluid disposal system 224
- Upgrading a System 220 or 222 to four collection containers

Benefits:

4 collection containers can be connected to the 220 liter storage container at the same time and drained.



4-liter collection container

Order no.: 03.9302-0516.2

Short order no.: 750005

Spare part for all ATE brake fluid disposal systems



Technical data:

Capacity:	4.2 liters
-----------	------------

220-liter storage container

Order no.: 03.9302-0514.2

Short order no.: 750004

Spare part for all ATE brake fluid disposal systems

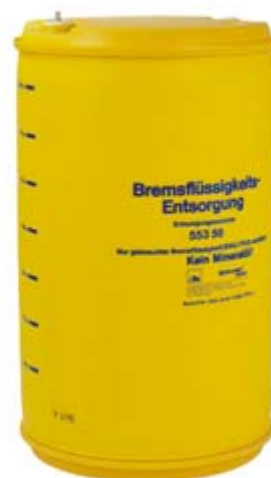

Technical data:

Capacity:	220 liters
-----------	------------



Digital brake disk caliper gauge

Order no.: 03.9314-0010.3

Short order no.: 760138

The digital ATE brake disk caliper gauge is an indispensable tool for precisely determining brake disk wear. It enables quick and easy measurement of brake disk thickness, i.e., the degree of wear. The measuring range is 125 mm and the length of the measuring jaws is 85 mm. The design of the measuring jaws permits exact measurement even if the disc has a ridge.

Work with the digital ATE brake disc caliper gauge couldn't be easier. After the measuring jaws have been positioned on the brake disk, the result of measurement is shown in figures on the display. The reading is saved by briefly pressing the hold button. The caliper gauge then can be opened and removed from the brake disk. The reading remains saved until the hold button is pressed again. This is a big advantage especially if accessibility is a problem or poor lighting conditions in the wheel well impede reading. The result of measurement thus can be conveniently read and compared with the desired value.

If required, null balancing of the gauge can be quickly initiated at the push of a button. The user can freely choose between "mm" and "inch" as units of measure.

The big advantage of the digital ATE brake disk caliper gauge is that no special know-how is required for taking readings. The digital reading display is self-explanatory even to laypersons and can be nicely used for sales talks with the customer.

The digital ATE brake disk caliper gauge is an indispensable tool for precisely determining brake disk wear. It enables quick and easy measurement of brake disk thickness, i.e., the degree of wear. The measuring range is 125 mm and the length of the measuring jaws is 85 mm. The design of the measuring jaws permits exact measurement even if the disc has a ridge.

Work with the digital ATE brake disc caliper gauge couldn't be easier. After the measuring jaws have been positioned on the brake disk, the result of measurement is shown in figures on the display. The reading is saved by briefly pressing the hold button. The caliper gauge then can be opened and removed from the brake disk. The reading remains saved until the hold button is pressed again. This is a big advantage especially if accessibility is a problem or poor lighting conditions in the wheel well impede reading. The result of measurement thus can be conveniently read and compared with the desired value.

If required, null balancing of the gauge can be quickly initiated at the push of a button. The user can freely choose between "mm" and "inch" as units of measure.

The big advantage of the digital ATE brake disk caliper gauge is that no special know-how is required for taking readings. The digital reading display is self-explanatory even to laypersons and can be nicely used for sales talks with the customer.

Benefits:

- Convenient, reliable reading of measurements
- Easy saving of readings
- Measuring jaw design permits accurate measurement even if a brake disk has a ridge
- Sturdy design suited for workshop use

Scope of supply:

- Complete instrument in sturdy plastic box
- Substitute battery
- Operating instructions



Piston return tool set

Order no.: 03.9314-4999.4
Short order no.: 760133

With floating calipers with an integrated parking brake (combined calipers), the piston must not simply be pushed back, as this would destroy the automatic adjustment mechanism in the caliper. In many cases the piston must be turned and pressed. This can be done using the ATE piston return tool set. With its right- and left threaded spindle and its 9 interchangeable adapters, it can be used for all common vehicles. It can also be used to return pistons in standard floating calipers.

Benefits:

9 assorted adapters for all common caliper types, including ATE and older Lucas calipers

Scope of supply:

- Metall case
- Right threaded spindle
- Left threaded spindle
- spacer sleeve and pressure plate
- 9 adapters



spindle left

Order no.: 03.9314-4994.2
Short order no.: 760135

For returning combination calipers with left thread return for piston return set 03.9314-4980.4 / 760102.



Piston return device

Order no.: 03.9314-4950.3
Short order no.: 760049

The ATE piston return device returns the pistons in the disk brake calipers. It avoids damage to the pistons and brake disks.

Benefits:

Parallel running ensures that the piston movement cannot cause damage and cannot jam.

Note:

Do not use tire levers / large screwdrivers!



45° piston turning tool

Order no.: 03.9314-5710.3

Short order no.: 760065

The ATE 45° piston turning tool allows the pistons in Lucas/Girling combined calipers to be returned easily.

Work flow:

Turn piston with slot through 45° (unlock) and push it back, then turn it back through 45° (lock).



Piston turning tool

Order no.: 03.9314-5720.3

Short order no.: 760066

The ATE piston turning tool makes it possible to completely turn back the pistons with slot in Altecna and Bendix combined calipers



Piston turning tool

Order no.: 03.9314-5700.3

Short order no.: 760064

The ATE piston turning tool is used to turn pistons with a shoulder to the correct position in the caliper. The ATE 20° piston gauge is also needed for this operation.

The ATE piston turning tool has hardened teeth to allow the piston to be gripped tightly. Its size can be adjusted using the three stop notches.

Benefits:

Size adjustable via 3 stop notches



20° piston gauge

Order no.: 03.9314-1700.1

Short order no.: 760044

Adjustment and testing gauge for 20° piston adjustment in the brake caliper in combination with the ATE piston turning tool



Technical data:

For piston diameter

35 - 38 mm

20° piston gauge

Order no.: 03.9314-0900.1

Short order no.: 760037

Adjustment and testing gauge for 20° piston adjustment in the brake caliper in combination with the ATE piston turning tool



Technical data:

For piston diameter

42 - 48 mm

20° piston gauge

Order no.: 03.9314-0600.1

Short order no.: 760036

Adjustment and testing gauge for 20° piston adjustment in the brake caliper in combination with the ATE piston turning tool



Technical data:

For piston diameter

52 - 57 mm

20° piston gauge

Order no.: 03.9314-5300.1

Short order no.: 760058

Adjustment and testing gauge for 20° piston adjustment in the brake caliper in combination with the ATE piston turning tool



Technical data:

For piston diameter	60 mm
---------------------	-------

Brake pad withdrawal tool

Order no.: 03.9314-6100.3

Short order no.: 760073

The ATE brake pad withdrawal tool removes firmly seated disk brake pads with retaining holes from fixed calipers. It prevents damage to brake calipers and disks. The fact that the pulling rod is integrated into the sliding weight means that there is no risk of injury.

Benefits:

Pulling rod integrated in the sliding weight, so that there is no risk of injury



Technical data:

Pulling pin diameter:	5.0 mm
-----------------------	--------

Brake caliper guide file

Order no.: 03.9314-1300.3

Short order no.: 760038

The ATE brake caliper guide file allows the brake pad guide surfaces on brake calipers and holders to be filed to a bright finish. Single-sided cutting ensures that no damage is caused to the dust cap. The special coarse teeth mean that the work is completed quickly and cleanly.

Benefits:

Special single-sided cut causes no damage to the dust cap.



Special wire brush

Order no.: 03.9314-1320.3

Short order no.: 760039

The ATE special wire brush is used to remove slight soiling on the brake pad guide surfaces of brake calipers and holders.

Note:

Wire brushes whose strands are seriously out of shape may cause damage to rubber protective caps. In this event, always use a new brush!



Wheel hub cleaning set 1

Order no.: 03.9314-1330.4

Short order no.: 760109

The ATE wheel hub cleaning set 1 for standard wheel hubs allows you to clean the wheel hub quickly, safely and at low cost, before the brake disks are fitted. The mounting face for the brake disks on the wheel hub must be bright before the disk is mounted to ensure that it lies fully flush. Only then can it be guaranteed that the installation tolerances of the brake disks can be adhered to.

The cleaning process does not normally take more than 10 seconds per hub. The hole in the cleaning disk provides firm guidance and ensures that the disk does not slip off the hub. The fact that the entire surface of the disk is used ensures a lifetime of approx. 400 cleaning operations.

Scope of supply:

- 1 holder
- 3 disks



Technical data:

Disk external Ø	160mm
Hole Ø	60mm

Wheel hub cleaning set 1-1/2

Order no.: 03.9314-1360.4

Short order no.: 760136

The ATE wheel hub cleaning set 1-1/2 is for use with 1/2" square air wrenches. It is suitable for standard wheel hubs and allows you to clean the wheel hub quickly, safely and at low cost, before the brake discs are fitted. The mounting face for the brake disks on the wheel hub must be bright before the disk is mounted to ensure that it lies fully flush. Only then can it be guaranteed that the installation tolerances of the brake disks can be adhered to.

The cleaning process does not normally take more than 10 seconds per hub. The hole in the cleaning disk provides firm guidance and ensures that the disk does not slip off the hub.

The fact that the entire surface of the disk is used ensures a lifetime of approx. 400 cleaning operations.



Scope of supply:

- 1 holder
- 1 disk

Technical data:

Disk external Ø	160mm
Hole Ø	60mm

Spare disks, Set 1

Order no.: 03.9314-1331.1

Short order no.: 760125

spare part

Scope of supply:

- 3 disks



Technical data:

Disk external Ø	160 mm
Hole Ø	60 mm

Wheel hub cleaning set 2

Order no.: 03.9314-1340.4

Short order no.: 760110

The ATE wheel hub cleaning set 2 for wheel hubs with studs allows you to clean the wheel hub quickly, safely and at low cost, before the brake disks are fitted. The mounting face for the brake disks on the wheel hub must be bright before the disk is mounted to ensure that it lies fully flush. Only then can it be guaranteed that the installation tolerances of the brake disks can be adhered to.

Two different sizes of cleaning disks and the corresponding holders allow the best possible finish around the studs over which the disks are passed.

The cleaning process does not normally take more than 10 seconds per hub. The hole in the cleaning disk provides firm guidance and ensures that the disk does not slip off the hub. The fact that the entire surface of the disk is used ensures a lifetime of approx. 400 cleaning operations.



Scope of supply:

- 2 holders
- 6 small disks
- 6 large disks

Technical data:

Disk small, external Ø	40 mm
Disk small, hole Ø	13 mm
Disk large, external Ø	53 mm
Disk large, hole Ø	13 mm

Spare disks small, Set 2

Order no.: 03.9314-1341.1

Short order no.: 760126

spare part

Scope of supply:

- 5 disks small

Technical data:

Disk small, external Ø	40 mm
Disk small, hole Ø	13 mm



Spare disks large, Set 2

Order no.: 03.9314-1342.1

Short order no.: 760127

spare part

Scope of supply:

- 5 disks large

Technical data:

Disk large, external Ø	53 mm
Disk large, hole Ø	13 mm



Wheel hub cleaning set 3

Order no.: 03.9314-1350.4

Short order no.: 760111

The ATE wheel hub cleaning set 3 for large wheel hubs or wheel hubs with a large clooar (e.g. Transporters and BMW vehicles) allows you to clean the wheel hub quickly, safely and at low cost, before the brake disks are fitted. The mounting face for the brake disks on the wheel hub must be bright before the disk is mounted to ensure that it lies fully flush. Only then can it be guaranteed that the installation tolerances of the brake disks can be adhered to.

The cleaning process does not normally take more than 10 seconds per hub. The hole in the cleaning disk provides firm guidance and ensures that the disk does not slip off the hub. The fact that the entire surface of the disk is used ensures a lifetime of approx. 400 cleaning operations.

Scope of supply:

- 1 holder
- 2 disks

Technical data:

Disk external Ø	200 mm
Hole Ø	85 mm



Spare disks, Set 3

Order no.: 03.9314-1351.1

Short order no.: 760128

spare part

Scope of supply:

- 2 disks

Technical data:

Disk external Ø	200 mm
Hole Ø	85 mm



Brake caliper wrench

Order no.: 03.9314-0024.1

Short order no.: 760097

The ATE brake caliper wrench allows simple loosening or tightening of the rear-axle brake caliper retaining bolts on the Opel Vectra B.

It is a sharply cranked 19 mm hexagon wrench with a ½" square drive for a socket driver.

It is thus no problem to tighten and loosen bolts hidden by other components.

Bolts can be tightened up to the correct torque

Benefits:

- It is thus no problem to tighten and loosen bolts hidden by other components.
- Bolts can be tightened up to the correct torque



Hexagon socket wrench 7 mm, short

Order no.: 03.9314-0030.1

Short order no.: 760095

The short 7 mm hexagon socket wrench is used to screw in/unscrew the guide studs on floating calipers.



Technical data:

Width across flats:	7 mm
Blade length (short):	35 mm
Square drive:	3/8"

Hexagon socket wrench 7 mm, long

Order no.: 03.9314-0031.1

Short order no.: 760096

The long 7 mm hexagon socket wrench is used to screw in/unscrew the guide studs on floating calipers.



Technical data:

Width across flats:	7 mm
Blade length (long):	62 mm
Square drive:	1/2"

Bush remover

Order no.: 03.9314-0022.2

Short order no.: 760098

The ATE bush remover is used to withdraw tightly seated bushes from the brake caliper guide on GMF floating calipers for the following types of vehicle: Opel Corsa A/B, Tigra, Kadett D/E, Ascona C, Vectra A, Calibra, Omega A/B, Senator B

Benefits:

The work can be carried out on the vehicle without disconnecting the caliper from the brake hydraulic system (no bleeding necessary).



Protective cap insertion tool

Order no.: 03.9314-0020.2

Short order no.: 760100

The ATE protective cap insertion tool is used to insert the internal protective caps of the bushes on GMF floating calipers for the following types of vehicle: Opel Corsa A/B, Tigra, Kadett D/E, Ascona C, Vectra A, Calibra, Omega A/B, Senator B

Benefits:

Damage-free and tight-fit insertion of protective caps



Protective cap driver

Order no.: 03.9314-0028.1

Short order no.: 760099

The ATE protective cap driver is used to drive on the external protective caps of the bushes on GMF floating calipers for the following types of vehicle: Opel Corsa A/B, Tigra, Kadett D/E, Ascona C, Vectra A, Calibra, Omega A/B, Senator B



Parking brake cable spring pliers

Order no.: 03.9309-0080.3

Short order no.: 760087

The ATE parking brake cable spring pliers allow simple and safe attachment of the parking brake cable to the brake shoe lever on drum brakes. It is particularly useful for mounting the ATE top kit.



Brake-spring pliers (small)

Order no.: 03.9309-0030.3

Short order no.: 760003

The ATE brake-spring pliers (small) allow the brake shoe return springs on drum brakes to be removed and mounted very easily and safely. The small swiveling support plate has a fine, sharp, diamond-cut surface which means that it gives firm support on narrow brake lining surfaces. The double-sided delicate hooks for attaching the springs allow springs to be attached to the left or right with no difficulty.



Technical data:

Span approx.:

80 mm

Brake-spring pliers (medium-size)

Order no.: 03.9314-5750.3
Short order no.: 760067

The ATE brake-spring pliers (small) allow the brake shoe return springs on drum brakes to be removed and mounted very easily and safely. The swiveling support plate has sharp claws to provide firm support on the brake lining surface. The hook allows the springs to be attached safely.



Technical data:

Span approx.:	100 mm
---------------	--------

Spring mounting pliers

Order no.: 03.9309-0090.3
Short order no.: 760105

The ATE spring mounting pliers allow safe and problem-free mounting and removal of the drum-brake shoe retaining spring system from Lucas, e.g. on the Mercedes A class. Without the ATE spring mounting pliers it is virtually impossible to deal with the retaining spring.



Benefits:

The retaining spring can only be mounted and removed quickly and safely with the help of the ATE spring mounting pliers.

Spring mounting tool

Order no.: 03.9309-0051.3
Short order no.: 760104

The ATE spring mounting tool is used for the safe and problem-free removal and mounting of the retaining plates of brake-shoe retaining springs. Two different size seating bells safely accommodate large and small spring plates of the brake-shoe retaining springs.



Spring mounting tool

Order no.: 03.9309-0040.3
Short order no.: 760004

The ATE spring mounting tool is used for the safe and problem-free removal and mounting of brake-shoe retaining springs on AP-Lockheed drum brakes.



Spring mounting tool

Order no.: 03.9309-0060.3
Short order no.: 760006

The ATE spring mounting tool is used for the safe and problem-free removal and mounting of brake-shoe retaining springs on Bosch-Bendix drum brakes.



Drum brake mounting set

Order no.: 03.9309-0070.3
Short order no.: 760007

The ATE drum brake mounting set contains the tools needed to mount and adjust drum brake shoes.

Scope of supply:

- Mounting tool for retaining springs
- Mounting tool for return springs
- Adjustment wrench for eccentric bolts, size 3/8" (9.5mm) and 7/16" (11.1mm)
- Adjusting lever



Piston clip

Order no.: 03.9309-0200.1
Short order no.: 760009

The ATE piston clip prevents the pistons from slipping out of wheel brake cylinders over 25.4 mm and so facilitates mounting.

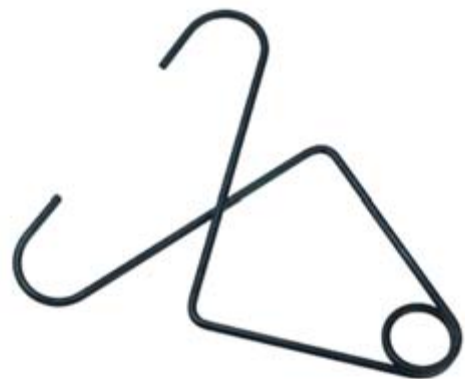

Brake shoe adjustment wrench

Order no.: 03.9309-0010.3

Short order no.: 760001

The ATE brake shoe adjustment wrench makes it simple to adjust the square eccentric bolts of the sizes $\frac{1}{2}$ " (6.3mm) and $\frac{5}{16}$ " (7.9mm) on difficult-to-access drum brakes.



Dual pipe-flaring tool

Order no.: 03.9310-0015.4

Short order no.: 760134

The ATE dual pipe-flaring tool allows brake pipes with diameters 4.75 and 6 mm to be flared easily and quickly to shapes E and F (DIN 74 234 / ISO 4038).

The two thrust members for each diameter are fitted in a holder which is simply slipped onto the flaring tool. Operation by means of an eccentric lever ensures that the flaring operation is completed quickly and safely. One particular feature is the smooth (non-serrated) jaws that clamp the brake pipe securely without damaging the surface.

Benefits:

- for brake pipe diameters of 4.75 and 6 mm
- easily exchangeable thrust members in holder
- smooth jaws – no damage to the surface of the brake pipe
- tidily stowed in a metal case

Scope of supply:

- Metal case
- Eccentric lever press with interlocking clamping device
- 2 sets of jaws
- 2 sets of thrust members for flaring



Professional dual pipe-flaring tool

Order no.: 03.9310-0001.4

Short order no.: 760012

The ATE professional pipe flaring tool allows brake pipes with diameters of 4.75, 6, 8 and 10 mm to be flared easily to shapes F (DIN 74 234 / ISO 4038).

The thrust members which rotate within the revolver system and operation by means of an eccentric lever ensure that the flaring operation is completed quickly and safely. One particular feature is the smooth (non-serrated) jaws that clamp the brake pipe securely without damaging the surface.

Benefits:

- for brake pipe diameters of 4.75, 6, 8 and 10 mm
- thrust members which rotate within the revolver system
- smooth jaws - no damage to the surface of the brake pipe
- clearly stowed in a plastic case

Scope of supply:

- Plastic case with shaped insert
- Eccentric lever press with interlock clamping device and revolving toothed rim
- 4 different jaws
- 4 different thrust members for flaring



Miniature pipe cutter

Order no.: 03.9310-0010.3

Short order no.: 760023

The small dimensions of the ATE mini-pipe cutter allow brake pipes with diameters from 3 to 16 mm to be cut to length in situ on the vehicle.

Benefits:

Thanks to its compact size, it can be used in situ on the vehicle



Pipe deburring tool

Order no.: 03.9310-0020.3

Short order no.: 760024

This 3-cutter combined tool allows brake pipes with diameters from 4.75 to 10 mm to be deburred internally and externally.



Pipe bending device

Order no.: 03.9310-0030.3
Short order no.: 760025

The ATE pipe bending tool permits easy bending of brake pipes with diameters of 4.75mm (3/16") and 6mm (1/4") even in situ on the vehicle, without reducing the cross-section.



Pipe bending pliers

Order no.: 03.9310-0040.3
Short order no.: 760026

The ATE pipe bending pliers provide practical assistance for bending and mounting brake pipes with a diameter of 4.75 mm (3/16").

Benefits:

- Bending of the brake pipe in a confined space
- Bending up to 90° is possible without causing damage
- Alignment of the pipe screw connections
- Holding the brake pipe while it is being cut



Brake pipe bending tool

Order no.: 03.9310-0010.1
Short order no.: 760101

The ATE brake pipe bending tool is a simple yet very practical aid for bending brake pipes with diameters of 4.75mm, 5.0mm or 3/16".

Benefits:

- Small handy tool
- Can be used in situ on the car and allows very small bending radii.



Brake pipe wrench set

Order no.: 03.9310-0050.3

Short order no.: 760027

The reinforced open ring wrench heads of the ATE brake pipe wrench set with hexagon heads hold the brake pipe screw joints firmly so that even tight joints can easily be loosened. The heads angled by 15 degrees.

Scope of supply:

6 double ring wrenches in a tool bag:
(8 + 10, 10 + 11, 11 + 13, 12 + 14 mm, 3/8 + 7/16 inches, 1/2 + 9/16 inches).



Reamer set for ABS sensor locating hole

Order no.: 03.9301-0001.3

Short order no.: 760106

The ATE reamer set for ABS sensor locating holes is used to quickly and accurately clean the locating hole of the ABS wheel-speed sensors. Reamer heads for two different diameters make the ATE reamer set universally usable.

The ratchet driver with the minimum possible drive angle allows it to be used even in confined spaces. Damage to the transducer rings is excluded. A clean, well-fitting sensor locating hole allows the sensors to be reinstalled easily.

Benefits:

- Reamer heads for two different diameters
- Ratchet driver with an extremely small drive angle means it can be used without difficulty even in a confined space
- Damage to the transducer rings is excluded

Scope of supply:

- Rigid plastic container
- ratchet driver
- Reamer head Ø 15mm
- Reamer head Ø 18mm



Reamer head Ø 15 mm

Order no.: 03.9301-0003.1

Short order no.: 760108

Spare part for reamer set for ABS sensor locating hole



Technical data:

Reamer head Ø	15 mm
---------------	-------

Reamer head Ø 18 mm

Order no.: 03.9301-0002.1

Short order no.: 760107

Spare part for reamer set for ABS sensor locating hole



Technical data:

Reamer head Ø	18 mm
---------------	-------

Brake hose clamp

Order no.: 03.9310-0060.3

Short order no.: 760028

The ATE brake hose clamp is used to clamp brake hoses during brake repairs or troubleshooting. This prevents the brake system from draining while repairs are underway. During troubleshooting, an individual wheel brake can be disabled.

Benefits:

The round shape of the clamping arms (Ø 10 mm) prevents damage to the brake hose.

Safety note:

- Always use the hose clamp in the middle of the brake hose.
- When work is complete, make sure that you remove the hose clamp!



Cap screws for fluid reservoir

Order no.: 03.9302-0784.2

Short order no.: 740071

The ATE aluminum fluid reservoir cap screws, without bleeder holes for a 45-mm buttress thread allow the fluid reservoir to be completely sealed. This prevents any water entering the reservoir during engine cleaning. The brake system cannot drain during assembly work.

Note:

When the work has been completed, replace the cap screws with the original connectors!



ATE brake cylinder paste (in tube)

Order no.: 03.9902-0501.2

Short order no.: 700009

ATE brake cylinder paste is used for repair, assembly and conservation of hydraulic brake components. It is applied thinly and evenly to cylinder sleeves, pistons and seals.

Benefits:

compatible with DOT 3, DOT 4 and DOT 5.1 brake fluids

Scope of supply:

180 g tube.

Note:

Safety note:

No mineral greases or oils may be used in places that come into contact with brake fluid.



Technical data:

Contents:	180 g
-----------	-------

ATE Plastilube 35 ml

Order no.: 03.9902-1001.2

Short order no.: 700014

ATE Plastilube lubricates and provides protection against corrosion for the guide surfaces of brake calipers and brake pads. To prevent squealing, ATE Plastilube is applied to the backing plates of the brake pads.

Benefits:

- Free from metal soaps and fatty acids, so it is not corrosive.
- Long-lasting, hence reduced maintenance frequency.
- Insoluble in water and outstanding resistance to leaching.
- Versatile as it is compatible with all metals and most O-ring materials.

Scope of supply:

24 tubes each holding 35 ml

Note:

Caution: Do not apply on brake pad friction surfaces

Technical data:

Contents:	35 ml
-----------	-------



ATE Plastilube 75 ml

Order no.: 03.9902-1002.2

Short order no.: 700015

ATE Plastilube lubricates and provides protection against corrosion for the guide surfaces of brake calipers and brake pads. To prevent squealing, ATE Plastilube is applied to the backing plates of the brake pads.

Benefits:

- Free from metal soaps and fatty acids, so it is not corrosive.
- Long-lasting, hence reduced maintenance frequency.
- Insoluble in water and outstanding resistance to leaching.
- Versatile as it is compatible with all metals and most O-ring materials.

Scope of supply:

12 tubes each holding 75 ml in display package

Note:

Caution: Do not apply on brake pad friction surfaces

Technical data:

Contents:	75 ml
-----------	-------





**ALFA ROMEO**

All passenger cars	1985-	03.9302-0702.2/02	20		
Giulietta	1981-1986	03.9302-0703.2/02	27	03.9302-0740.2/02	38A

ASTON MARTIN

DB7 Vantage		03.9302-0702.2/02	20	03.9302-0702.2/02	20
V12 Vanquish		03.9302-0702.2/02	20		

AUDI

All passenger cars	1980-	03.9302-0702.2/02	20		
--------------------	-------	-------------------	----	--	--

BENTLEY

All passenger cars	2001-	03.9302-0702.2/02	20		
--------------------	-------	-------------------	----	--	--

BMW

All passenger cars	1980-	03.9302-0702.2/02	20		
Motorcycle R60-R100 if brake master cylinder below tank	1973-1980	03.9302-0702.2/02	20		

CADILLAC

All passenger cars	1996-	03.9302-0923.2/02	61A		
BLS	2005-	03.9302-0702.2/02	20		
CTS (DOT 3) !	2001-	03.9302-0923.2/02	61A		

CHEVROLET

All passenger cars	1999-	03.9302-0923.2/02	61A		
Astro-Van	1996-	03.9302-0930.2/02	12		
Blazer	1996-1998	03.9302-0931.2/02	13		
Corvette	1996-	03.9302-0923.2/02	61A		
Hummer H2	2003-	03.9302-0923.2/02	61A		
S10 Pick-Up 2WD + 4WD	1996-	03.9302-0931.2/02	13		
Surburban	1996-	03.9302-0930.2/02	12		
Tahoe	1996-2002	03.9302-0930.2/02	12		

CHRYSLER

Tutti i veicoli	1988-	03.9302-0901.3/02	22+22/1		
Crossfire	2003-	03.9302-0702.2/02	20		
300M 2.7 Executive	1999-	03.9302-0914.2/02	77		
Reservoir in cast iron	-1996	03.9302-0931.2/02	13		
Neon Sport 16V	1996-	03.9302-0914.2/02	77		
Neon LE 1,6	2001-	03.9302-0902.2/02	22	03.9302-0702.2/02	20
New Yorker		03.9302-0914.2/02	77		
PT Cruiser	2001-	03.9302-0902.2/02	22	03.9302-0702.2/02	20
Sebring	2001-	03.9302-0914.2/02	77		
Stratus	1999-	03.9302-0914.2/02	77		
Viper	2003-	03.9302-0902.2/02	22		
Vision		03.9302-0923.2/02	61A		
Grand Voyager	1999-2001	03.9302-0914.2/02	77		
Grand Voyager	2002	03.9302-0902.2/02	22		
Voyager LE	1996 -	03.9302-0902.2/02	22		
Voyager SE	1994-	03.9302-0901.3/02	22+22/1		
Voyager SE 2,4	2001-	03.9302-0902.2/02	22	03.9302-0925.2/02	31
Voyager LX 2,5	2001-	03.9302-0902.2/02	22	03.9302-0925.2/02	31

CITROEN

2CV		03.9302-0702.2/02	20		
-----	--	-------------------	----	--	--



2CV4 drum brake (front)		03.9302-0787.2/02	54A		
Dyane drum brake (front)		03.9302-0787.2/02	54A		
Ami 6/8		03.9302-0787.2/02	54A		
AX		03.9302-0702.2/02	20		
Berlingo		03.9302-0702.2/02	20		
Berlingo	1998-	03.9302-0740.2/02	38A		
C2	2003-	03.9302-0702.2/02	20		
C3	2003-	03.9302-0702.2/02	20		
C5	2001-	03.9302-0702.2/02	20		
C6	2005-	03.9302-0702.2/02	20		
C8	2003-	03.9302-0927.2/02	50S		
Evasion		03.9302-0702.2/02	20		
Jumper	1998-	03.9302-0927.2/02	50S		
Jumpy	1998-	03.9302-0702.2/02	20		
Saxo		03.9302-0702.2/02	20		
Visa		03.9302-0702.2/02	20		
Xara	2003-	03.9302-0740.2/02	38A		
ZX		03.9302-0702.2/02	20		
DACIA					
1210 / 1310 / 1410		03.9302-0702.2/02	20		
Logan	2005-	03.9302-0702.2/02	20		
DAEWOO					
Aveo	2005-	03.9302-0702.2/02	20		
Espero		03.9302-0702.2/02	20	03.9302-0704.2/02	67
Evanda	2003-	03.9302-0923.2/02	61A		
Kalos	2003-	03.9302-0702.2/02	20		
Lacetti	2003-	03.9302-0702.2/02	20		
Lanos		03.9302-0702.2/02	20		
Leganza	1999-	03.9302-0766.2/02	45		
Matiz + ABS	1999-	03.9302-0916.2/02	35		
Nexia		03.9302-0702.2/02	20	03.9302-0704.2/02	67
Nubira	1999-2000	03.9302-0702.2/02	20		
Nubira	2001-	03.9302-0923.2/02	61A		
Rezzo CDX	2001-	03.9302-0703.2/02	27	03.9302-0703.2/02	27
DAF					
V 400		03.9302-0731.2/02	71		
Passenger car type 45		03.9302-0702.2/02	20		
Truck series 45= 150/160/180/210	1998-			03.9302-0740.2/02	38A
Truck series 65-85CF	1998-	03.9302-0740.2/02	38A		
Truck series 95+F	1998-			03.9302-0740.2/02	38A
DAIHATSU					
Applause	1999-	03.9302-0909.2/02	79		
Applause (A101)	1995-	03.9302-0737.2/02	73		
Charade	1989-	03.9302-0909.2/02	79		
Charade (G200)	1995-	03.9302-0737.2/02	73		
Charmant	1989-	03.9302-0787.2/02	54A		
Copen	2003-	03.9302-0912.2/02	82		



Cuore / Charade	-1989	03.9302-0787.2/02	54A		
Cuore	1989-1997	03.9302-0909.2/02	79		
Cuore	1998-1999	03.9302-0945.2/02	85		
Cuore (L501)	1995-	03.9302-0737.2/02	73		
Cuore (L701)	1999-	03.9302-0912.2/02	82		
Cuore	2001-	03.9302-0945.2/02	85		
Cuore (L251)	2005-	03.9302-0929.2/02	82A		
Feroza	1995-	03.9302-0737.2/02	73		
Hijet 4WD / Sta.Wag.	1989-	03.9302-0737.2/02	73		
Hijet S 86	1995-	03.9302-0737.2/02	73		
Move	1999-	03.9302-0737.2/02	73		
Move	2001-	03.9302-0945.2/02	85		
Move (L901)		03.9302-0787.2/02	54A		
Gran Move	1999-	03.9302-0737.2/02	73		
Gran Move (G301)		03.9302-0906.2/02	55A		
Rocky EL 4WD		03.9302-0737.2/02	73		
Rocky EX 4WD		03.9302-0737.2/02	73		
Rocky Mod. F75/78	1995-	03.9302-0737.2/02	73		
Sirion	1998-	03.9302-0737.2/02	73		
Sirion (M100; M101)		03.9302-0787.2/02	54A		
Sirion (M101)	2001-2002	03.9302-0945.2/02	85		
Sirion (M100, M101, M111)	2003-	03.9302-0912.2/02	82		
Terios	1997-	03.9302-0909.2/02	79		
Terios (J102)		03.9302-0909.2/02	79	03.9302-0925.2/02	31
YRV (M201)		03.9302-0787.2/02	54A		
YRV (M201)	2001-	03.9302-0945.2/02	85		
FERRARI					
All passenger cars		03.9302-0702.2/02	20		
FIAT					
All passenger cars		03.9302-0702.2/02	20	03.9302-0702.2/02	20
127		03.9302-0703.2/02	27		
126 + Argenta		03.9302-0734.2/02	76		
Barchetta Coupe	1998-	03.9302-0734.2/02	76		
Cinquecento		03.9302-0734.2/02	76		
Daily 45 mm diameter		03.9302-0703.2/02	27		
Daily 26.5 mm diameter		03.9302-0731.2/02	71		
Doblo	2001-	03.9302-0702.2/02	20		
Ducato	1998-	03.9302-0927.2/02	50S		
Multipla	2000-	03.9302-0703.2/02	27		
Punto + ABS	1996-	03.9302-0734.2/02	76		
Scudo	1998-	03.9302-0702.2/02	20		
Seicento		03.9302-0734.2/02	76		
Ulysse		03.9302-0927.2/02	50S		
FORD					
All passenger cars		03.9302-0702.2/02	20		
Econovan		03.9302-0799.2/02	17		
Explorer		03.9302-0914.2/02	77		



Galaxy	-2003	03.9302-0702.2/02	20		
Galaxy	2003-	03.9302-0948.2/02	20S		
Maverick + Ranger	1996-	03.9302-0914.2/02	77	03.9302-0774.2/02	43
Navigator (USA)	2001-	03.9302-0914.2/02	77		
Probe	-1992	03.9302-0910.2/02	72		
Ranger	1999-	03.9302-0746.2/02	49	03.9302-0702.2/02	20
Transit Van	1971-1981	03.9302-0731.2/02	71		
Transit Van	1998-	03.9302-0702.2/02	20		
Tourneo Connect		03.9302-0702.2/02	20		
Truck Series N		03.9302-0717.2/02	68		
Windstar	1996-	03.9302-0938.2/02	77A		
GENERAL MOTORS					
Vehicles with ITT ABS MkIV		03.9302-0923.2/02	61A		
HONDA					
Civic+Accord+Prelude	1976-1983	03.9302-0767.2/02	47		
Accord	1985-1992	03.9302-0911.2/02	80		
Accord	1996-	03.9302-0911.2/02	80	03.9302-0925.2/02	31
Accord	1999-	03.9302-0911.2/02	80		
Accord	2001-	03.9302-0946.2/02	86	03.9302-0703.2/02	27
Accord	2003-	03.9302-0946.2/02	86	03.9302-0799.2/02	17
Civi Shuttle		03.9302-0787.2/02	54A		
Civic	1992-	03.9302-0918.2/02	81		
Civic	1996-	03.9302-0918.2/02	81	03.9302-0925.2/02	31
Civic (EJ 9)	1999-	03.9302-0918.2/02	81	03.9302-0767.2/02	47
Civic	2001-	03.9302-0946.2/02	86	03.9302-0799.2/02	17
Concerto		03.9302-0918.2/02	81		
CRV		03.9302-0918.2/02	81		
CRV	2003-	03.9302-0946.2/02	86	03.9302-0799.2/02	17
CRX 1,6		03.9302-0787.2/02	54A		
CRX 1,6	1997-	03.9302-0918.2/02	81	03.9302-0767.2/02	47
HR-V	1999-	03.9302-0918.2/02	81	03.9302-0767.2/02	47
Insight	1999-	03.9302-0918.2/02	81		
Jazz		03.9302-0946.2/02	86	03.9302-0799.2/02	17
Legend	1991-	03.9302-0918.2/02	81		
Legend V6 2,7		03.9302-0740.2/02	38A		
Logo	1999-	03.9302-0918.2/02	81		
NSX-T (1981- =DOT3)	1999-	03.9302-0911.2/02	80	03.9302-0767.2/02	47
Odyssey (US-Minivan)	1999-	03.9302-0918.2/02	81		
Prelude	-1991	03.9302-0911.2/02	80		
Prelude	1992-	03.9302-0918.2/02	81		
Prelude 2,0		03.9302-0906.2/02	55A		
S 2000	1999-	03.9302-0918.2/02	81	03.9302-0767.2/02	47
S 2000	2001-	03.9302-0946.2/02	86		
Shuttle	1997-	03.9302-0911.2/02	80		
Stream	2001-	03.9302-0946.2/02	86	03.9302-0799.2/02	17
HYUNDAI					
Accent	1995-	03.9302-0914.2/02	77	03.9302-0774.2/02	43



Atos	1999-	03.9302-0914.2/02	77		
Centenial	1999-	03.9302-0914.2/02	77		
Coupe	1999-	03.9302-0914.2/02	77		
Elantra	2001-	03.9302-0914.2/02	77	03.9302-0774.2/02	43
Getz	2003-	03.9302-0943.2/02	90		
Grandeur	2005-	03.9302-0914.2/02	77		
H-1 Ssarex	1998-	03.9302-0914.2/02	77		
H-1	2001-	03.9302-0914.2/02	77		
H100	1995	03.9302-0904.2/02	14A		
H100	1996-	03.9302-0934.2/02	63		
Lantra		03.9302-0914.2/02	77		
Lantra II	1995-	03.9302-0914.2/02	77	03.9302-0774.2/02	43
Matrix		03.9302-0914.2/02	77		
Pony		03.9302-0914.2/02	77	03.9302-0774.2/02	43
Santa Fe	2001-	03.9302-0914.2/02	77		
Sonata		03.9302-0914.2/02	77		
Sonata	1995-	03.9302-0914.2/02	77	03.9302-0774.2/02	43
Terracan		03.9302-0914.2/02	77	03.9302-0774.2/02	43
Trajet	2001-	03.9302-0938.2/02	77A		
Tucson		03.9302-0914.2/02	77		
XG 30 / XG 350		03.9302-0914.2/02	77		
ISUZU					
Frontera	1989-	03.9302-0912.2/02	82	03.9302-0704.2/02	67
Gemini		03.9302-0737.2/02	73		
Midi		03.9302-0913.2/02	24		
Monterey	1989-	03.9302-0912.2/02	82	03.9302-0704.2/02	67
NPR 65+69	1998-	03.9302-0774.2/02	43		
NPR 69	1998-	03.9302-0774.2/02	43		
NQR 70	1998-	03.9302-0774.2/02	43		
Rodeo		03.9302-0912.2/02	82		
Trooper	-1989	03.9302-0787.2/02	54A		
Trooper	1989-	03.9302-0912.2/02	82	03.9302-0704.2/02	67
IVECO					
Daily 30.8-35.8		03.9302-0702.2/02	20		
M series 155.14-175.24		03.9302-0702.2/02	20		
MK 75.9		03.9302-0702.2/02	20		
Type 30.8-49.10		03.9302-0702.2/02	20		
Type 80.13-130.13		03.9302-0702.2/02	20		
Zeta 50.9 109.14		03.9302-0736.2/02	37		
Turbo-Daily 59-12, 35-10, 49-12, 35-12, 30-8		03.9302-0702.2/02	20		
All Euro-Cargo models		03.9302-0919.2/02	32	03.9302-0702.2/02	20
JAGUAR					
Jaguar XJ 40 + XJ6		03.9302-0740.2/02	38A		
Jaguar XJ 12 SerieIII		03.9302-0790.2/02	57		
Jaguar XJ 6 SerieIII		03.9302-0790.2/02	57		
Jaguar XJS	2005-	03.9302-0790.2/02	57		
Jaguar XJ Twin TD	2005-	03.9302-0702.2/02	20		



Jaguar XKR	1999-	03.9302-0702.2/02	20		
Jaguar XJR	1999-	03.9302-0702.2/02	20		
Jaguar Sovereign 4.0		03.9302-0702.2/02	20		
Jaguar S-Type V8	1999-	03.9302-0914.2/02	77		
Jaguar S-Type R	2003-	03.9302-0702.2/02	20		
Jaguar X-Type	2001-	03.9302-0702.2/02	20		
Jaguar Daimler Super V8		03.9302-0702.2/02	20		
JEEP					
Jeep	Urtyp	03.9302-0922.2/02	15		
Jeep Cherokee	-1995	03.9302-0914.2/02	77		
Jeep Cherokee	1996-	03.9302-0902.2/02	22		
Jeep Wrangler	1996-	03.9302-0901.3/02	22+22/1		
Jeep Wrangler Sport	1999-	03.9302-0902.2/02	22		
Jeep Wrangler	2003-	03.9302-0902.2/02	22	03.9302-0702.2/02	20
Jeep Grand Cherokee	1996-	03.9302-0902.2/02	22		
KIA					
Besta	1997-	03.9302-0799.2/02	17		
Carens	1999-	03.9302-0914.2/02	77		
Carens	2001-	03.9302-0702.2/02	20		
Carnival	1999-	03.9302-0799.2/02	17		
Cerato	2005-	03.9302-0914.2/02	77		
Clarus	1997-	03.9302-0702.2/02	20		
Joice		03.9302-0914.2/02	77		
Magentis	2001-	03.9302-0914.2/02	77	03.9302-0774.2/02	43
Opirius	2003-	03.9302-0702.2/02	20		
Picanto	2005-	03.9302-0914.2/02	77		
Pride	1995-	03.9302-0906.2/02	55A		
Rio	2000-2002	03.9302-0906.2/02	55A		
Rio	2003-	03.9302-0914.2/02	77		
Sephia	1995-	03.9302-0702.2/02	20		
Shuma	2000-	03.9302-0702.2/02	20		
Sorento	2003-	03.9302-0702.2/02	20		
Sportage	1995-	03.9302-0702.2/02	20		
LADA					
All passenger cars	1985-	03.9302-0703.2/02	27	03.9302-0734.2/02	76
Typ 2110, 2111, 2112		03.9302-0740.2/02	38A		
Typ 11128	2005-	03.9302-0740.2/02	38A		
LAMBORGHINI					
All passenger cars		03.9302-0702.2/02	20		
LANCIA					
All passenger cars	-1991	03.9302-0702.2/02	20		
A 112		03.9302-0734.2/02	76		
Thema		03.9302-0703.2/02	27		
Phetra	2005-	03.9302-0927.2/02	50S		
LAND ROVER					
Land-Rover Discovery	1995-	03.9302-0702.2/02	20	03.9302-0702.2/02	20
Land-Rover Discovery XS	2001-	03.9302-0926.2/02	28		



Land-Rover Defender	1999-	03.9302-0702.2/02	20		
Land-Rover Freelander	1999-	03.9302-0926.2/02	28		
Land-Rover Freelander+Sport	2001-	03.9302-0702.2/02	20		
Range-Rover		03.9302-0702.2/02	20		
Range-Rover Vogue / EFI		03.9302-0702.2/02	20	03.9302-0731.2/02	71
Range-Rover 4.6 HSE	1999-	03.9302-0702.2/02	20		
LEXUS					
All passenger cars	1990-	03.9302-0925.2/02	31	03.9302-0925.2/02	31
MASERATI					
3200 GT	1999-	03.9302-0702.2/02	20		
Quattroporte	1999-	03.9302-0702.2/02	20		
Spyder Cambiocorsa	2001-	03.9302-0927.2/02	50S		
MAZDA					
121	1995-	03.9302-0914.2/02	77		
121 LX		03.9302-0787.2/02	54A		
2	2003-	03.9302-0702.2/02	20		
3	2003-	03.9302-0702.2/02	20		
323	1991-	03.9302-0746.2/02	49		
323 LXD/GLX		03.9302-0746.2/02	49		
323 C + F	1995-	03.9302-0746.2/02	49		
323 P1.5 Luxury	1999-	03.9302-0746.2/02	49		
323 S1.5 Exclusive	1999-	03.9302-0746.2/02	49		
5	2005-	03.9302-0702.2/02	20		
626	1995-	03.9302-0746.2/02	49		
626 GD	1991-	03.9302-0910.2/02	72		
626 GE	1992-	03.9302-0746.2/02	49		
626 station wagon	1998-	03.9302-0746.2/02	49		
626 LX / GLX		03.9302-0787.2/02	54A		
6	2003-	03.9302-0923.2/02	61A		
B2500 PickUp 4WD	1998-	03.9302-0702.2/02	20	03.9302-0702.2/02	20
B series 2.5L TD	1999-	03.9302-0702.2/02	20		
B series 2.5L TD	2001-	03.9302-0746.2/02	49		
929	1986-	03.9302-0746.2/02	49		
B2500		03.9302-0746.2/02	49		
Demio	1998-	03.9302-0906.2/02	55A		
E2000 + E2200 mini van		03.9302-0799.2/02	17		
E2200 Transporter	1998-	03.9302-0799.2/02	17		
Lexus / LX + Sport		03.9302-0787.2/02	54A		
MPV	-1998	03.9302-0746.2/02	49		
MPV	1999-2000	03.9302-0914.2/02	77		
MPV	2001-	03.9302-0923.2/02	61A		
MX-3		03.9302-0746.2/02	49		
MX-5	-1994	03.9302-0746.2/02	49		
MX-5	1995-1998	03.9302-0910.2/02	72	03.9302-0702.2/02	20
MX-5	1999-2000	03.9302-0914.2/02	77		
MX-5	2001-2004	03.9302-0906.2/02	55A	03.9302-0746.2/02	49
MX-5	-2005	03.9302-0702.2/02	20		



MX-6		03.9302-0746.2/02	49		
Premacy		03.9302-0923.2/02	61A		
RX 7-Turbo		03.9302-0746.2/02	49		
RX 8	2003-	03.9302-0923.2/02	61A		
Tribute	2001-	03.9302-0914.2/02	77		
Xedos		03.9302-0746.2/02	49		
Xedos-6	1995-	03.9302-0746.2/02	49		
Xedos-9	1995-	03.9302-0746.2/02	49		
MERCEDES BENZ					
All passenger cars	1970-	03.9302-0702.2/02	20		
Vaneo		03.9302-0702.2/02	20		
G-Modell		03.9302-0703.2/02	27	03.9302-0703.2/02	27
207 / 209 / 310 / 609 Van		03.9302-0702.2/02	20		
Type 1814 truck				03.9302-0740.2/02	38A
Unimog (with twin hose)		03.9302-0740.2/02	2x38A		
MB 100: Up to chassis no. 021971 no bleeding is possible with a bleeder; bleeding must be done by pumping with pedal. From chassis no. 021972 with a bleeder, pressure max. 0.5-1.0 bar!!					
Sprinter		03.9302-0740.2/02	38A		
MINI					
All passenger cars	2001-	03.9302-0702.2/02	20		
MITSUBISHI					
Canter	1996-	03.9302-0936.2/02	69		
Carisma	1995-	03.9302-0928.2/02	34		
Carisma fastback	1999-	03.9302-0736.2/02	37	03.9302-0774.2/02	43
Carisma notchback	1999-	03.9302-0736.2/02	37		
Colt 1300 CI		03.9302-0736.2/02	37		
Colt CLXi		03.9302-0736.2/02	37	03.9302-0774.2/02	43
Eclipse		03.9302-0736.2/02	37	03.9302-0774.2/02	43
Colt	2004-	03.9302-0740.2/02	38A		
Galant	-1987	03.9302-0786.2/02	41		
Galant D	-1987	03.9302-0786.2/02	41		
Galant 1800 GLS Kat.		03.9302-0736.2/02	37		
Galant GTI/GLSI+station wagon		03.9302-0736.2/02	37	03.9302-0774.2/02	43
Galant	2000-	03.9302-0786.2/02	41	03.9302-0944.2/02	84
Galopper	1999-	03.9302-0914.2/02	77	03.9302-0774.2/02	43
Grandis	2003-	ohne	89		
Grandis	2003-	03.9302-0947.2/02	89		
L200		03.9302-0736.2/02	37		
L200	1998-	03.9302-0786.2/02	41	03.9302-0774.2/02	43
L300 Kleinbus	1988-	03.9302-0904.2/02	14A		
L400	1998-	03.9302-0933.2/02	62A		
Lancer (all types)		03.9302-0736.2/02	37	03.9302-0774.2/02	43
Lancer	1985-	03.9302-0786.2/02	41		
Lancer Turbo	1977-1980	03.9302-0786.2/02	41		
Lancer	2003-	03.9302-0914.2/02	77		



Outlander	2003-	03.9302-0914.2/02	77		
Pajero	-1989	03.9302-0786.2/02	41		
Pajero	1990-	03.9302-0736.2/02	37	03.9302-0774.2/02	43
Pajero Sport	1999-	03.9302-0786.2/02	41	03.9302-0774.2/02	43
Pajero 3,2	2001-	03.9302-0914.2/02	77	03.9302-0944.2/02	84
Pinin		03.9302-0914.2/02	77	03.9302-0774.2/02	43
Santamo		03.9302-0914.2/02	77	03.9302-0774.2/02	43
Sapporo	1980-1984	03.9302-0786.2/02	41		
Sapporo 2400		03.9302-0736.2/02	37		
Sigma		03.9302-0786.2/02	41		
Space Gear	1995-	03.9302-0933.2/02	62A		
Space Runner	1999-	03.9302-0914.2/02	77		
Space Star	1999-	03.9302-0928.2/02	34		
Space Star	2000-	03.9302-0736.2/02	37		
Space Wagon	1984-1989	03.9302-0786.2/02	41		
Space Wagon	1990-	03.9302-0736.2/02	37	03.9302-0774.2/02	43
Space Wagon (GDI)	1999-	03.9302-0914.2/02	77		
Station Wagon	2003-	03.9302-0914.2/02	77		
Cordia, Tredia, Starion, Colt	1978-1984	03.9302-0736.2/02	37		
MOSKVICH					
2140 / 2141		03.9302-0702.2/02	20		
NISSAN					
100 NX	1993-	03.9302-0914.2/02	77		
200 NX	1993-	03.9302-0906.2/02	55A		
200 SX	1995-	03.9302-0914.2/02	77		
200 SX - Turbo Maxima 3,0		03.9302-0906.2/02	55A		
350 Z	2003-	03.9302-0914.2/02	77	03.9302-0774.2/02	43
Almera	1995-	03.9302-0914.2/02	77		
Bluebird 2,0 SLX/Hatchback		03.9302-0906.2/02	55A		
Inter Star X 70	-2005	03.9302-0702.2/02	20		
Micra GL + LX		03.9302-0787.2/02	54A		
Micra	1993-2002	03.9302-0914.2/02	77		
Micra	2003-	03.9302-0702.2/02	20		
Maxima QX	1995-	03.9302-0914.2/02	77	03.9302-0774.2/02	43
Murano Z 50	2006-	03.9302-0914.2/02	77		
Navara D40	2006-	03.9302-0702.2/02	20		
Noblesse	2005-	03.9302-0914.2/02	77		
Note E 11	2006-	03.9302-0702.2/02	20		
Pathfinder+ RS1	2005-	03.9302-0914.2/02	77		
Patrol GR TD6	1999-	03.9302-0914.2/02	77	03.9302-0774.2/02	43
Patrol Turbo D		03.9302-0787.2/02	54A	03.9302-0766.2/02	45
Pick Up		03.9302-0906.2/02	55A	03.9302-0774.2/02	43
Pick Up	2001-	03.9302-0914.2/02	77		
Primera	1993-	03.9302-0914.2/02	77		
Rodius	2005-	03.9302-0914.2/02	77		
Serena	1993-	03.9302-0914.2/02	77		
Sherry		03.9302-0766.2/02	45		



Sunny	1993-	03.9302-0914.2/02	77		
Sunny GTI	1989-	03.9302-0787.2/02	54A	03.9302-0774.2/02	43
Sunny SLX / Coupe SLX + 1,3 LX		03.9302-0787.2/02	54A		
Terrano	1989-1992	03.9302-0766.2/02	45		
Terrano	1993-	03.9302-0906.2/02	55A		
Terrano II	1999-	03.9302-0914.2/02	77	03.9302-0774.2/02	43
Urvan		03.9302-0921.2/02	11A		
Vanette Cargo	1995-	03.9302-0914.2/02	77	03.9302-0774.2/02	43
X-Trail	2001-	03.9302-0914.2/02	77		
OPEL					
All passenger cars	1980-	03.9302-0702.2/02	20		
Agila (bleed clutch from bottom to top)	2000-	03.9302-0740.2/02	38A	03.9302-0704.2/02	67
Arena	1998-	03.9302-0740.2/02	38A		
Campo		03.9302-0912.2/02	82	03.9302-0907.2/02	26
Movano	1998-	03.9302-0702.2/02	20		
Frontera		03.9302-0912.2/02	82	03.9302-0907.2/02	26
Monterey		03.9302-0912.2/02	82	03.9302-0907.2/02	26
OPC Turbo	2003-	03.9302-0740.2/02	38A		
Sintra		03.9302-0923.2/02	61A	03.9302-0702.2/02	20
Zafira		03.9302-0740.2/02	38A		
PEUGEOT					
All passenger cars	1980-	03.9302-0702.2/02	20		
Typ 204, 504		03.9302-0737.2/02	73		
Typ 304 S		03.9302-0744.2/02	73A		
Boxer		03.9302-0740.2/02	38A		
Expert		03.9302-0702.2/02	20		
Partner		03.9302-0702.2/02	20		
807		03.9302-0927.2/02	50S		
PONTIAC					
Firebird + Cabrio		03.9302-0923.2/02	61A		
Trans Sport		03.9302-0923.2/02	61A		
PORSCHE					
All passenger cars	-1976	03.9302-0703.2/02	27		
All passenger cars	1977-	03.9302-0702.2/02	20		
Carrera 2**	1989-				
**Clamp bleeding line pressure-tight with clamping device to bleed; after bleeding, remove clamping device!					
PROTON					
315 GLSI	1999-	03.9302-0786.2/02	41		
316 GLSI	1999-	03.9302-0736.2/02	37	03.9302-0774.2/02	43
318 GLSI	1999-	03.9302-0736.2/02	37	03.9302-0774.2/02	43
413 GLSI	1999-	03.9302-0736.2/02	37		
415 GLI	1995-	03.9302-0736.2/02	37		
415 GLSI	1999-	03.9302-0786.2/02	41		
416 GLSI	1999-	03.9302-0736.2/02	37	03.9302-0774.2/02	43
Carmony Plus	1997-	03.9302-0736.2/02	37		

**RENAULT**

All passenger cars	1980-	03.9302-0702.2/02	20		
Espace		03.9302-0740.2/02	38A		
Modus	2005-	03.9302-0927.2/02	50S		
Scenic	2003-	03.9302-0740.2/02	38A		
Master	1998-	03.9302-0702.2/02	20		
Tracer		03.9302-0702.2/02	20	03.9302-0702.2/02	20
Traffic		03.9302-0740.2/02	38A		
B 120.50		03.9302-0702.2/02	20		
Bus FR1/GTX, FR1E, R312		03.9302-0702.2/02	20	03.9302-0702.2/02	20
G, R, AE row					
M 200.13		03.9302-0702.2/02	20		
M 230.13		03.9302-0702.2/02	20		
S 120.08 Midliner		03.9302-0702.2/02	20		
S 140.09		03.9302-0702.2/02	20		
S 160.08		03.9302-0702.2/02	20		
S 160.09 Midliner		03.9302-0702.2/02	20		

ROVER

Mini + 1300 Special	-1988	03.9302-0729.2/02	65	03.9302-0731.2/02	71
Mini Special	1988-	03.9302-0702.2/02	20	03.9302-0731.2/02	71
Mini Cooper	1999-	03.9302-0702.2/02	20	03.9302-0731.2/02	71
Maestro		03.9302-0702.2/02	20		
Montego		03.9302-0702.2/02	20		
Metro MG / HL / HLE		03.9302-0702.2/02	20	03.9302-0702.2/02	20
MG F-Steptronic	1999-	03.9302-0926.2/02	28		
MG ZR 160		03.9302-0926.2/02	28		
MG ZS 180		03.9302-0911.2/02	80		
MG IVVC	1999-	03.9302-0926.2/02	28		
25		03.9302-0926.2/02	28		
45		03.9302-0911.2/02	80		
75 + Tourer	1999-	03.9302-0702.2/02	20		
800 / 820 / 825 / 827		03.9302-0740.2/02	38A		
420 / 600		03.9302-0911.2/02	80	03.9302-0925.2/02	31
200 / 214 / 800	1995-	03.9302-0926.2/02	28		
200	1999-	03.9302-0926.2/02	28		
400		03.9302-0911.2/02	80		

SAAB

All passenger cars	1980-	03.9302-0702.2/02	20		
--------------------	-------	-------------------	----	--	--

SCANIA

Modell P, R, T				03.9302-0702.2/02	20
Modell 93 / 13 / 143				03.9302-0702.2/02	20

Other clutches can only be bled with special connection fittings from bottom to top. Special connection fittings can only be obtained via Scania. The bleeding can be done using a normal pressure-release brake bleeder.

SEAT



All passenger cars	1993-	03.9302-0702.2/02	20		
Alhambra	2003-	03.9302-0948.2/02	20S		
SKODA					
All passenger cars	1996-	03.9302-0702.2/02	20		
120 L		03.9302-0764.2/02	39		
135 L Favorit		03.9302-0764.2/02	39		
SMART MCC					
Smart		03.9302-0702.2/02	20		
Smart ForFour		03.9302-0740.2/02	38A		
SSANG YOUNG					
Korando		03.9302-0923.2/02	61A	03.9302-0766.2/02	45
Korando	2003-	03.9302-0914.2/02	77		
Kyron	2005-	03.9302-0914.2/02	77		
Musso		03.9302-0923.2/02	61A	03.9302-0766.2/02	45
Musso E32	2001-	03.9302-0914.2/02	77		
Noblesse	2005-	03.9302-0914.2/02	77		
Rexton		03.9302-0914.2/02	77		
Rodius	2005-	03.9302-0914.2/02	77		
STEYR					
Tractors		03.9302-0728.2/02	64A		
SUBARU					
Coupe 1800	1988-	03.9302-0786.2/02	41		
Forester	1999-	03.9302-0914.2/02	77		
Forester	2000-	03.9302-0914.2/02	77	03.9302-0916.2/02	35
Impreza 1,8GL		03.9302-0786.2/02	41		
Impreza 4WD	1998-	03.9302-0914.2/02	77		
Impreza WRX	2001-	03.9302-0914.2/02	77	03.9302-0916.2/02	35
Justy	1995-	03.9302-0736.2/02	37		
Justy	2003-	03.9302-0702.2/02	20		
Legacy	1995-	03.9302-0915.2/02	78		
Legacy + station wagon	1999-	03.9302-0914.2/02	77	03.9302-0916.2/02	35
Legacy Sedan 1800		03.9302-0915.2/02	78		
Legacy Sedan 2200		03.9302-0915.2/02	78		
Legacy	2005-	03.9302-0914.2/02	77		
Libero	1993-	03.9302-0914.2/02	77		
Libero E10 + E12 mini van	1988-	03.9302-0916.2/02	35		
Outback	1989-	03.9302-0914.2/02	77	03.9302-0916.2/02	35
Sedan 1800 4WD		03.9302-0786.2/02	41		
Station Wagon 1800	1988-	03.9302-0786.2/02	41		
Super Justy	1988-	03.9302-0786.2/02	41		
Turismo	1983-	03.9302-0766.2/02	45		
SUZUKI					
Alto	1996-	03.9302-0939.2/02	83		
Alto GA/GL	-1989	03.9302-0766.2/02	45		
Baleno	1996-	03.9302-0932.2/02	42		
		03.9302-0746.2/02	49		
Baleno ABS +1.3GS + GL	1996-	03.9302-0914.2/02	77		
Baleno Holiday	1999-	03.9302-0914.2/02	77		



Ignis + Sport	2001-	03.9302-0916.2/02	35		
Ignis	2003-	03.9302-0702.2/02	20		
Jimny	1999-	03.9302-0917.2/02	60	03.9302-0774.2/02	43
JLX	1996-	03.9302-0917.2/02	60		
Liana	2001-	03.9302-0932.2/02	42	03.9302-0774.2/02	43
Maruti		03.9302-0916.2/02	35		
SA 310 + SA 413	1988-	03.9302-0765.2/02	46		
Samurei	1993-	03.9302-0702.2/02	20		
Samurei Van	1989-	03.9302-0906.2/02	55A		
Samurei Van + Pick Up	1999-	03.9302-0702.2/02	20		
SJ Samurei + SJ 413	1985-	03.9302-0906.2/02	55A		
Swift	1996-	03.9302-0786.2/02	41		
Swift 1,0GA / 1,3GL	-1989	03.9302-0767.2/02	47		
Swift 13 + SF 413	1989-	03.9302-0917.2/02	60		
Swift SF 310	1989-	03.9302-0917.2/02	60		
Swift 1,3 + 1,5	2005-	03.9302-0702.2/02	20		
Vitara	1989-	03.9302-0787.2/02	54A		
Vitara	1991-	03.9302-0917.2/02	60		
Vitara + Grand 2.0	1999-	03.9302-0917.2/02	60	03.9302-0774.2/02	43
Vitara + Grand XZL-7	2001-	03.9302-0914.2/02	77	03.9302-0774.2/02	43
Wagon R+	1999-	03.9302-0939.2/02	83		
Wagon R+	2003-	03.9302-0702.2/02	20		
TOYOTA					
Avensis	1998-	03.9302-0702.2/02	20	03.9302-0767.2/02	47
Avensis Verso	2003-	03.9302-0935.2/02	31A		
Aygo	2005-	03.9302-0740.2/02	38A		
4-Runner	1996-	03.9302-0925.2/02	31		
Camry	1993-	03.9302-0925.2/02	31		
Camry		03.9302-0937.2/02	70	03.9302-0767.2/02	47
Carina	1993-	03.9302-0925.2/02	31		
Carina II / 2,0 GLI / 16V		03.9302-0937.2/02	70	03.9302-0767.2/02	47
Celica 4WD		03.9302-0767.2/02	47	03.9302-0767.2/02	47
Celica GT 2,0 / GT 1600		03.9302-0767.2/02	47	03.9302-0767.2/02	47
Celica GT 2,0 / GT 1600	2001-	03.9302-0925.2/02	31		
Celica CS	2003-	03.9302-0925.2/02	31		
Corolla		03.9302-0937.2/02	70	03.9302-0767.2/02	47
Corolla E11		03.9302-0925.2/02	31	03.9302-0925.2/02	31
Corolla	1993-	03.9302-0925.2/02	31		
Corolla	1996-	03.9302-0767.2/02	47		
Corolla	2003-	03.9302-0702.2/02	20		
Cressida	1977-1981	03.9302-0765.2/02	46		
Crown	1985-	03.9302-0906.2/02	55A		
Hiace	1996-	03.9302-0767.2/02	47		
Hiace mini van		03.9302-0905.2/02	16A		
Hilux		03.9302-0767.2/02	47	03.9302-0767.2/02	47
Hilux	2005-	03.9302-0925.2/02	31		
Landcruiser		03.9302-0765.2/02	46	03.9302-0767.2/02	47



Landcruiser HJ100		03.9302-0925.2/02	31		
Liteace		03.9302-0905.2/02	16A		
MR 2	2003-	03.9302-0925.2/02	31		
Picnic	1999-	03.9302-0935.2/02	31A		
Previa		03.9302-0905.2/02	16A		
Prius	2001-	03.9302-0925.2/02	31		
RAV 4	1996-	03.9302-0767.2/02	47	03.9302-0767.2/02	47
RAV 4	2003-	03.9302-0925.2/02	31		
Starlet		03.9302-0937.2/02	70	03.9302-0767.2/02	47
Tercel		03.9302-0937.2/02	70	03.9302-0767.2/02	47
Verso	1999-2002	03.9302-0925.2/02	31		
Verso	2003-	03.9302-0702.2/02	20		Verso
Yaris		03.9302-0925.2/02	31		
Yaris (special model)		03.9302-0702.2/02	20		
VOLVO					
All passenger cars		03.9302-0702.2/02	20		
FL 608		03.9302-0922.2/02	15	03.9302-0702.2/02	20
FL 611		03.9302-0922.2/02	15	03.9302-0702.2/02	20
S 40 / V 40		03.9302-0928.2/02	34		
FLC 6 Serie 7,5 - 12t		03.9302-0799.2/02	17	03.9302-0799.2/02	17
FH 12 series from 12 tonnes only clutch				03.9302-0799.2/02	17
FL 7 / 10 / 12 + FM series				03.9302-0799.2/02	17
Buses B 12 + B 10 B				03.9302-0799.2/02	17
VOLKSWAGEN					
All passenger cars	1973-	03.9302-0702.2/02	20		
1500 (Typ 1)		03.9302-0728.2/02	64A		
1500 / 1600 (Typ 3)		03.9302-0728.2/02	64A		
411 / 412 (Typ 4)		03.9302-0728.2/02	64A		
Beetle	1998-2002	03.9302-0740.2/02	38A		
Beetle	2003-	03.9302-0948.2/02	20S		
EOS	2005-	03.9302-0948.2/02	20S		
Lupo		03.9302-0927.2/02	50S		
Sharan		03.9302-0948.2/02	20S		
Touran	2005-	03.9302-0948.2/02	20S		
Taro		03.9302-0767.2/02	47	03.9302-0767.2/02	47
Transporter (Type 2) (diameter 28mm)		03.9302-0728.2/02	64A		
Transporter (Type 2) (diameter 45mm)		03.9302-0702.2/02	20		
Transporter (Type 2) Model T4	1994-	03.9302-0702.2/02	20		
LT 28		03.9302-0728.2/02	64A		
LT 31		03.9302-0728.2/02	64A		
LT 35		03.9302-0728.2/02	64A		
WARTBURG					
All passenger cars		03.9302-0702.2/02	20		

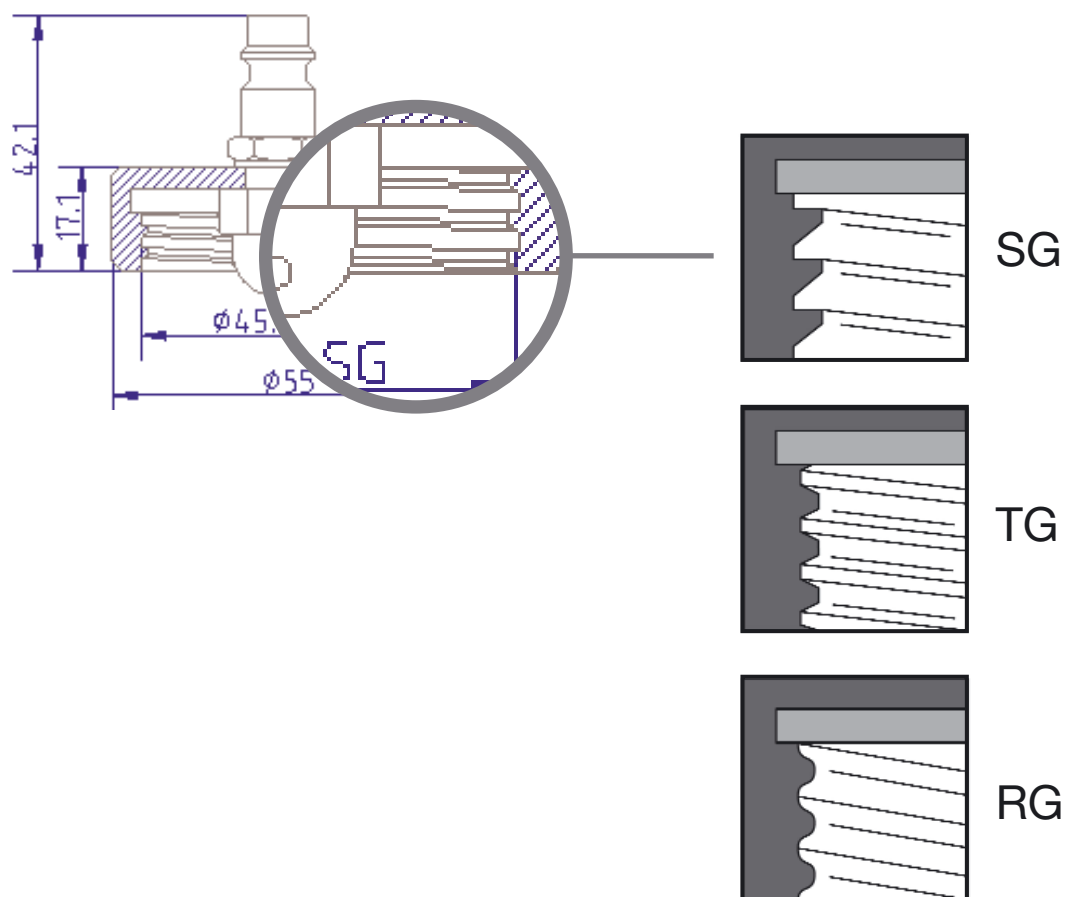

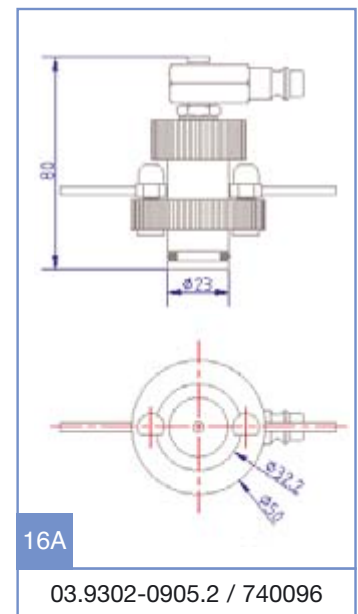
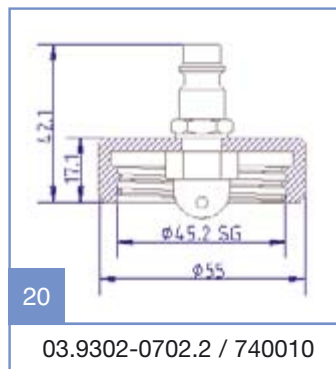
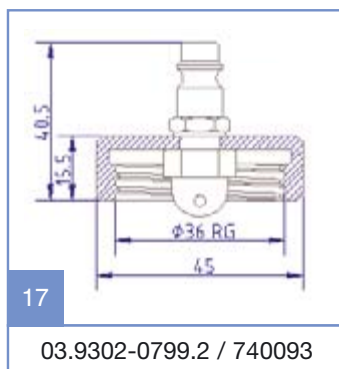
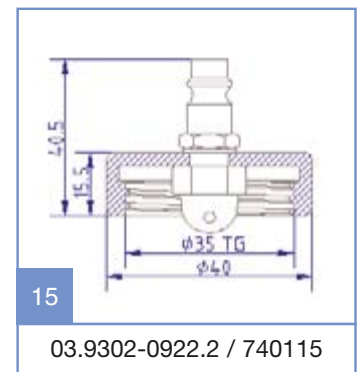
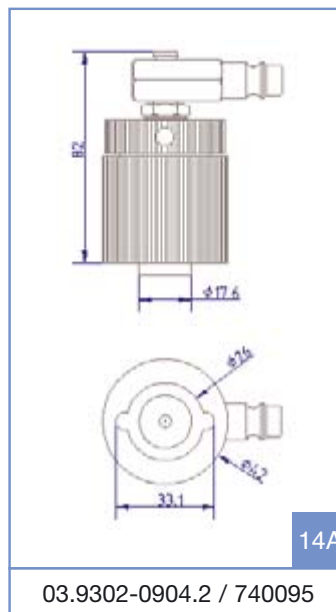
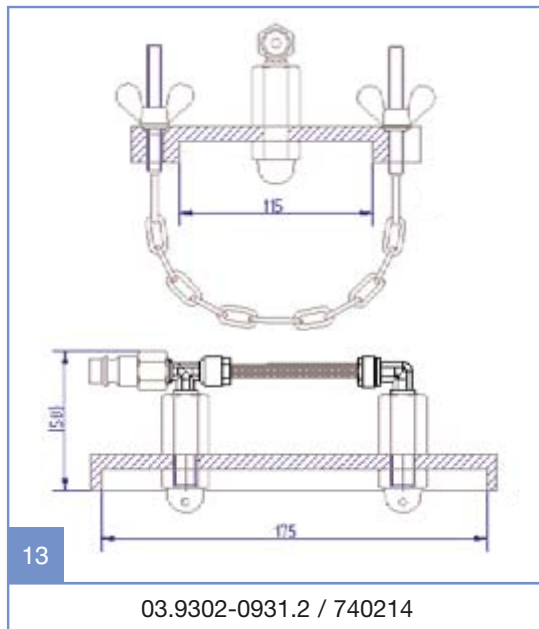
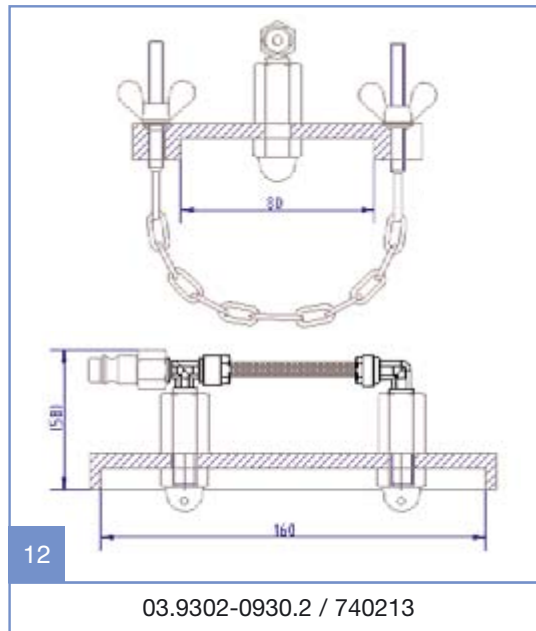
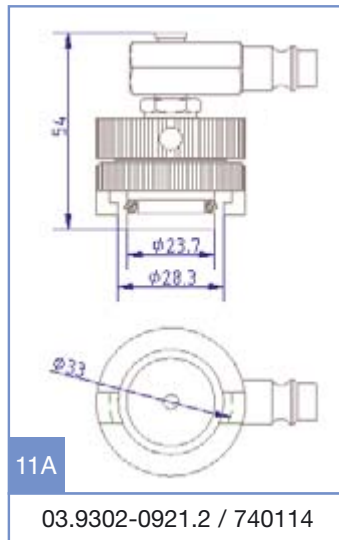

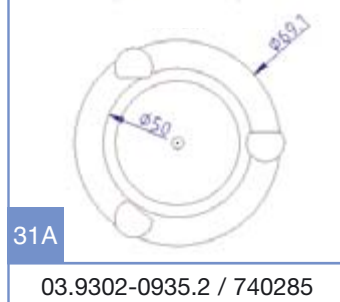
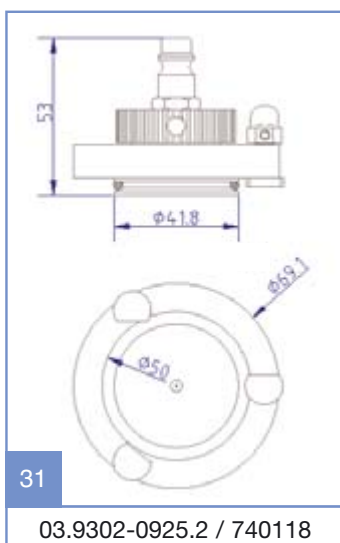
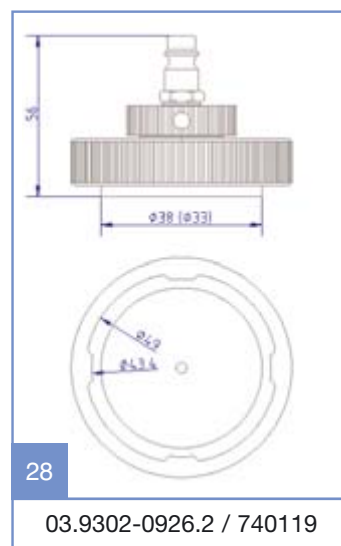
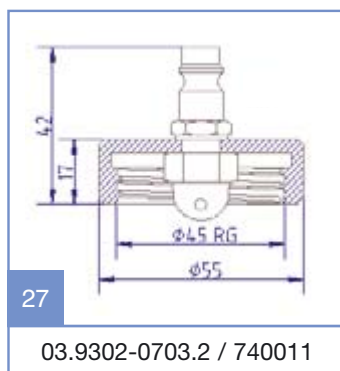
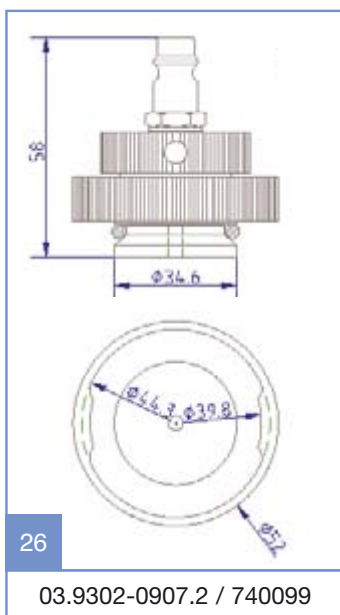
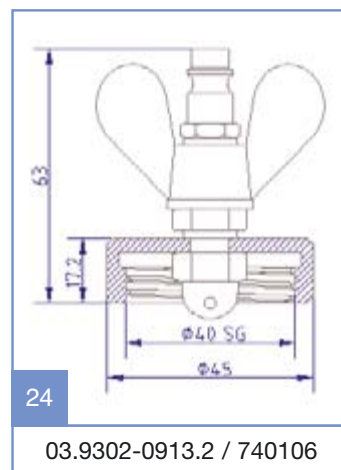
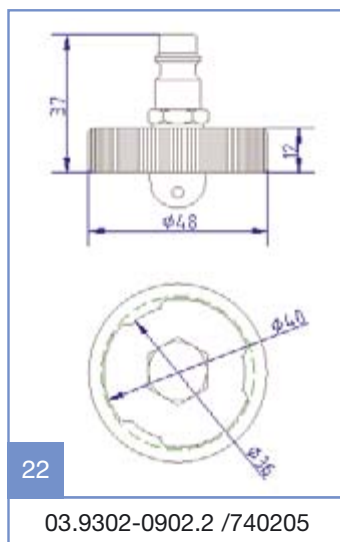
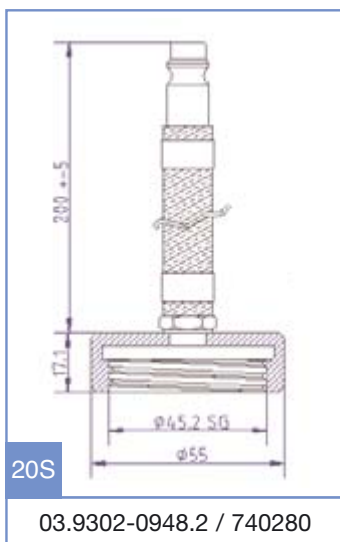

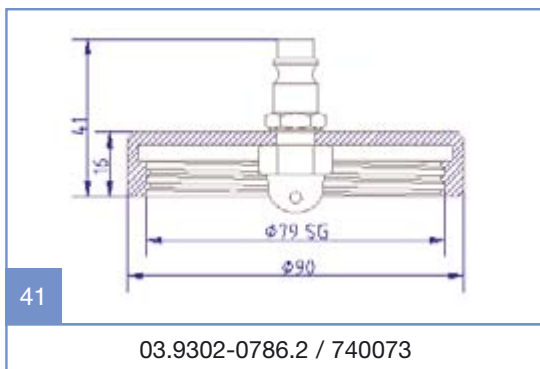
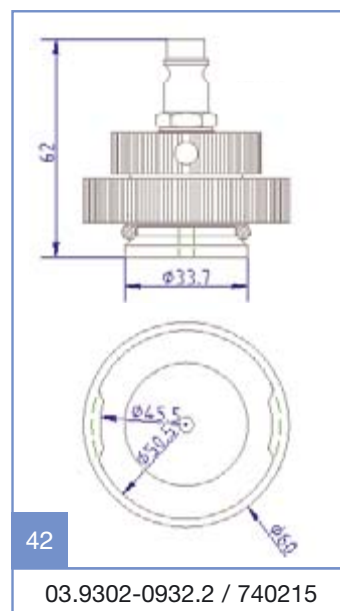
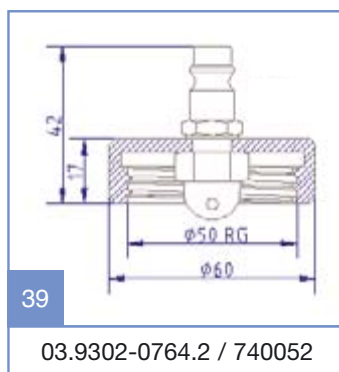
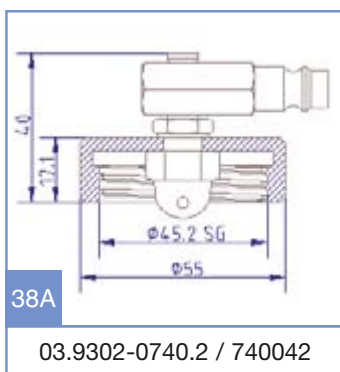
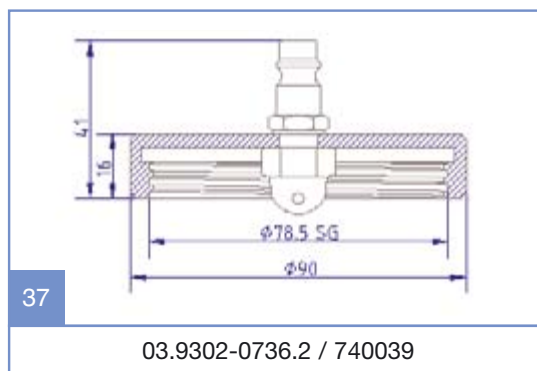
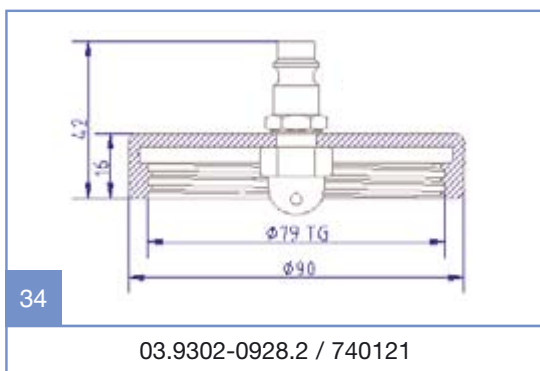
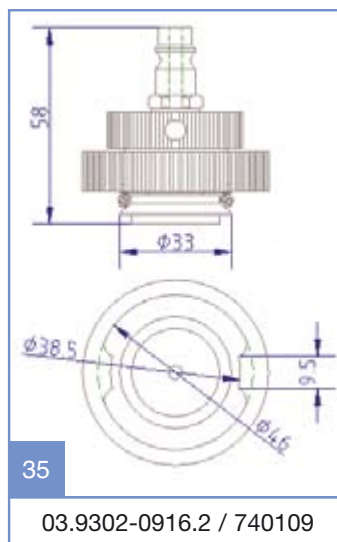
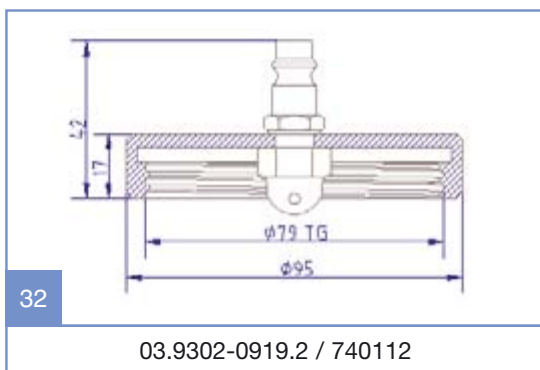

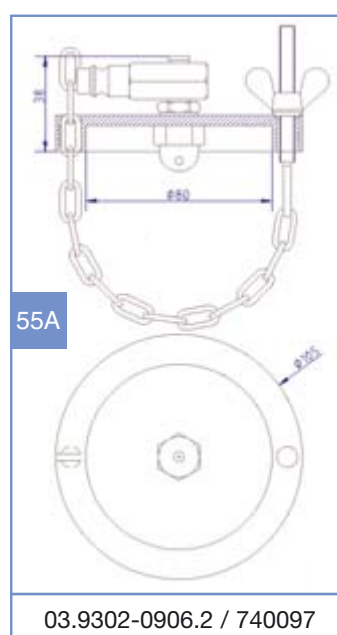
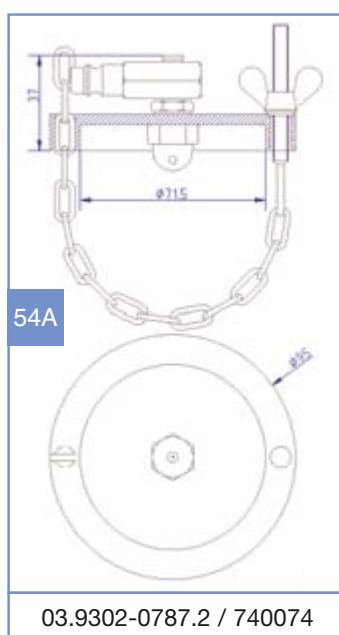
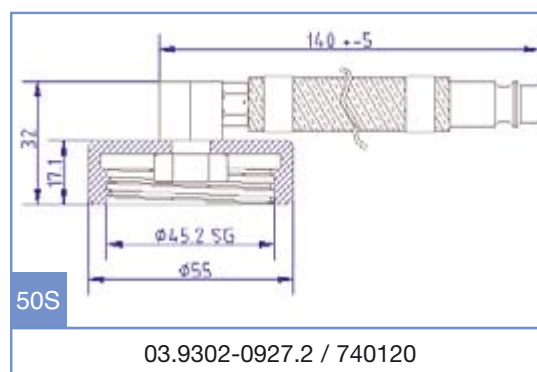
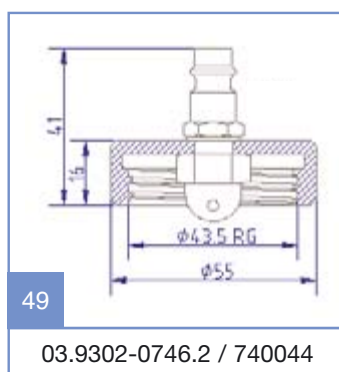
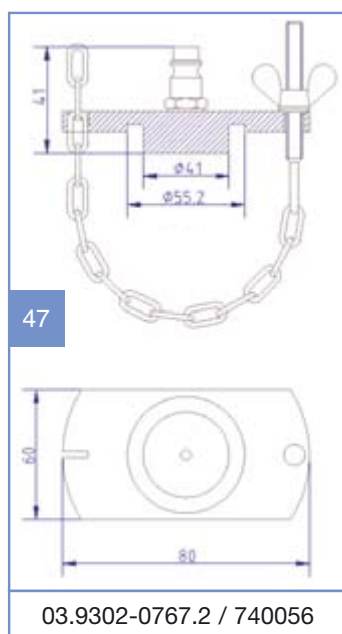
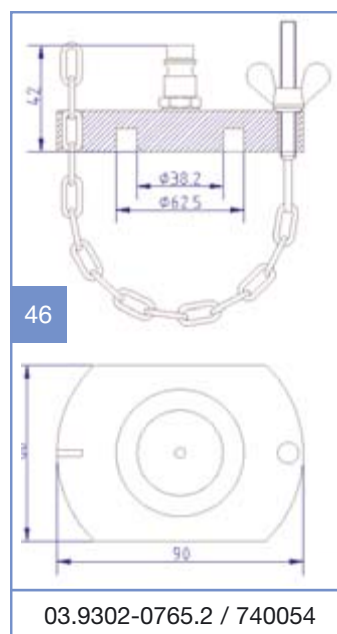
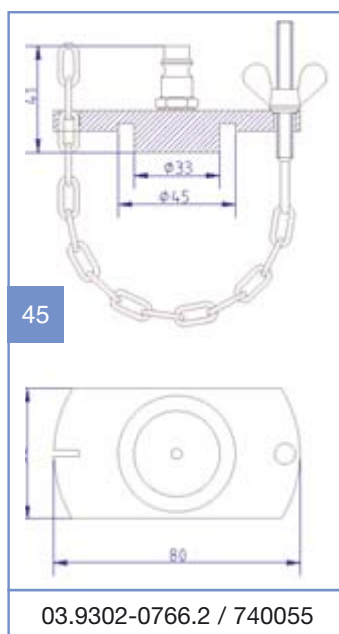
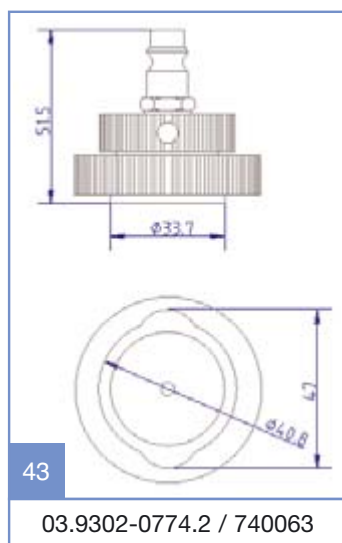

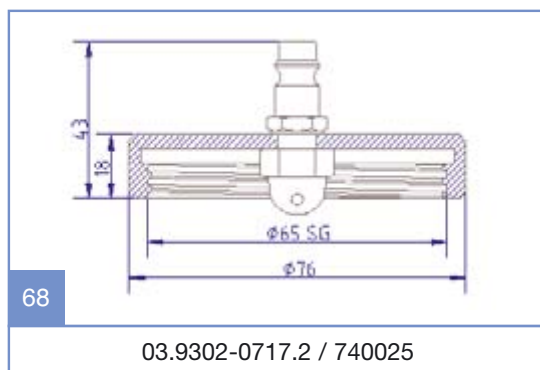
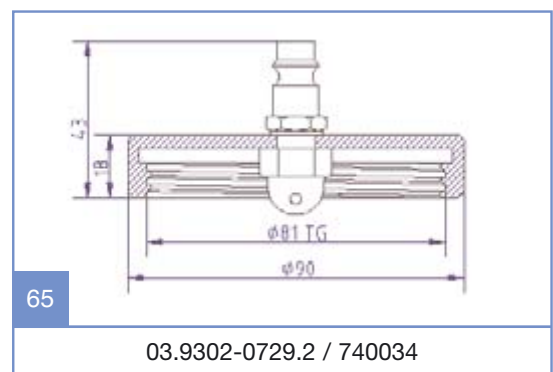
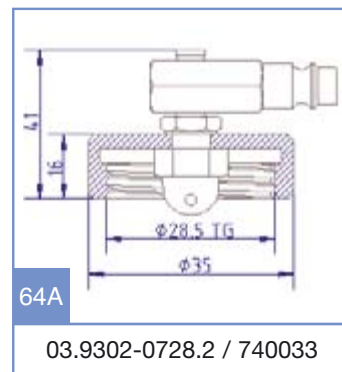
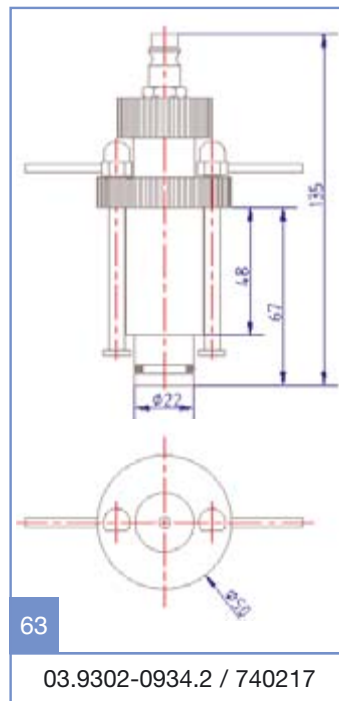
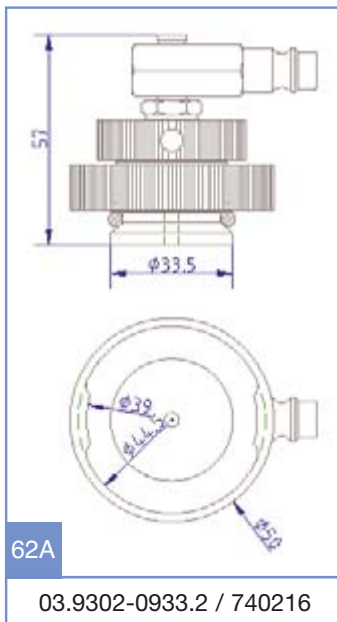
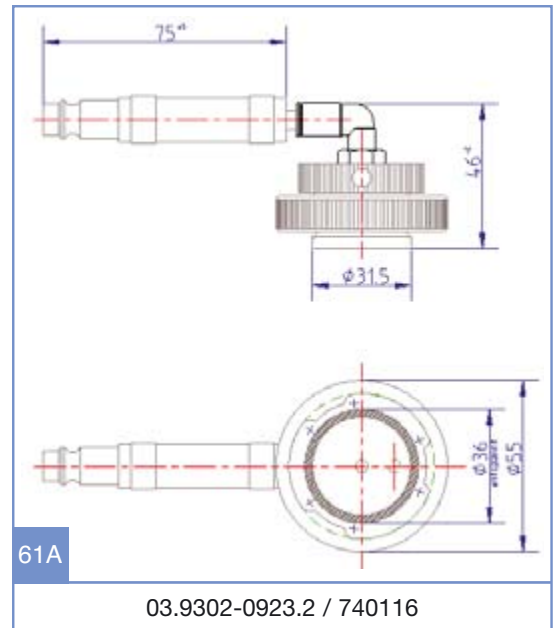
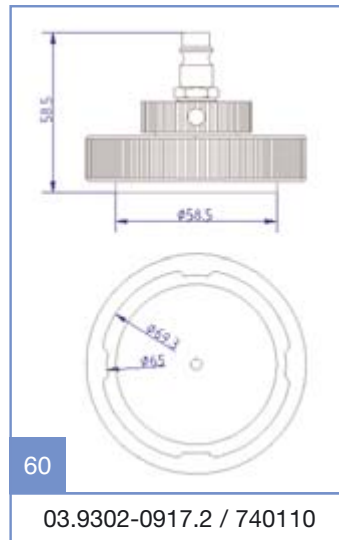
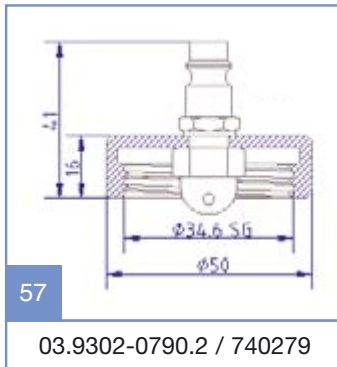

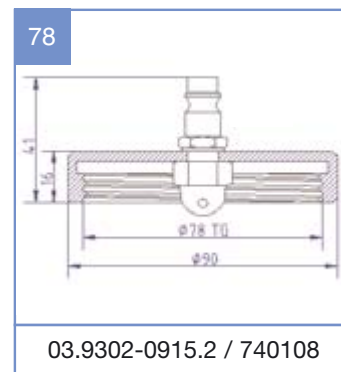
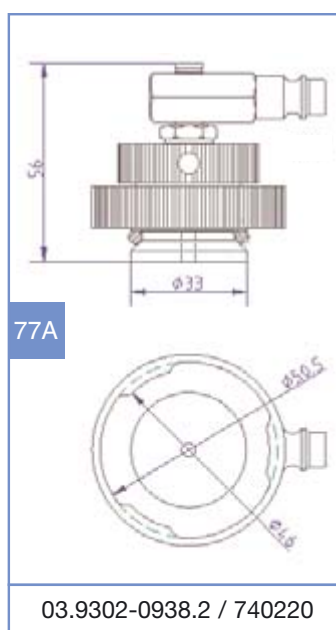
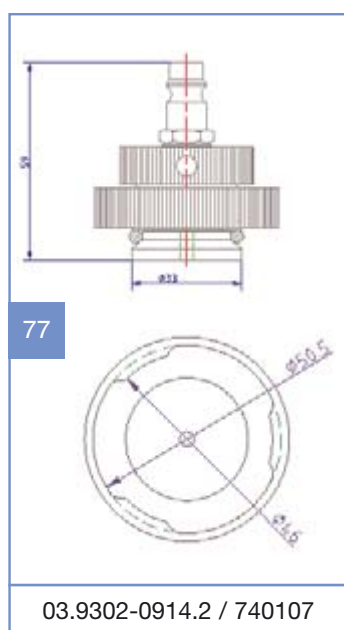
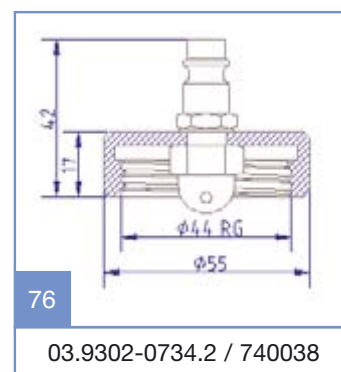
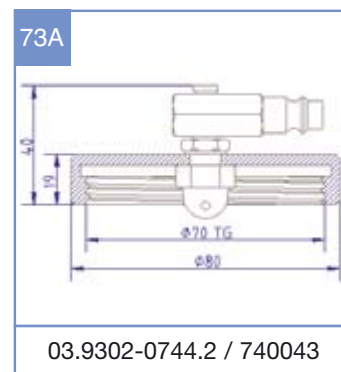
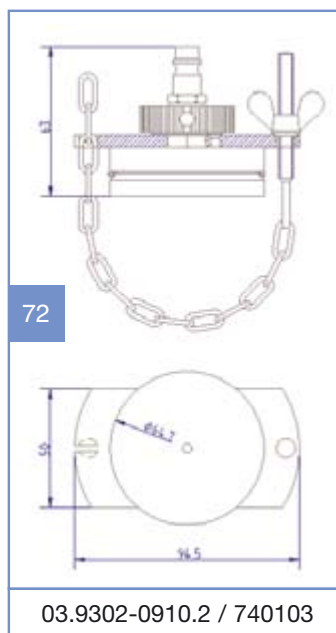
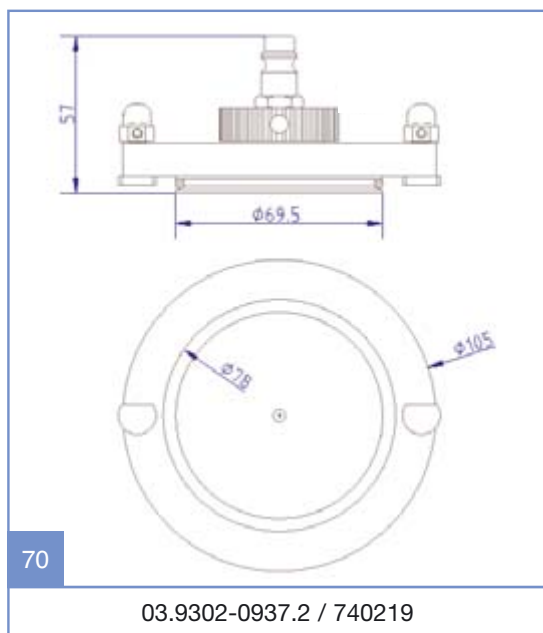
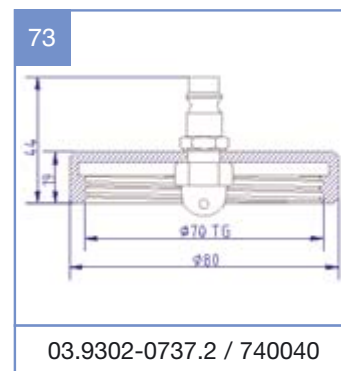
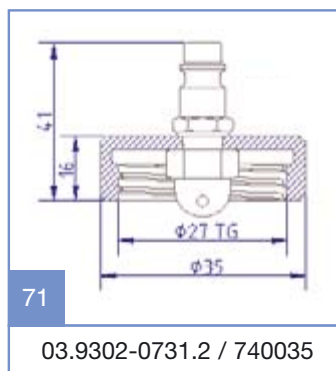
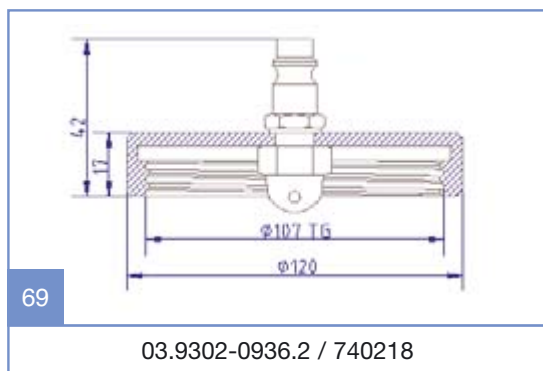

79

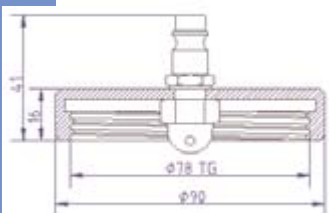

03.9302-0909.2 / 740284

80

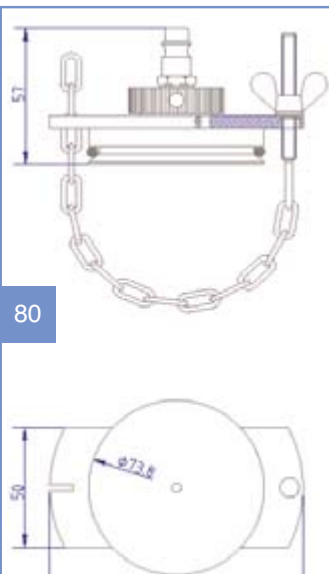

03.9302-0911.2 / 740104

81

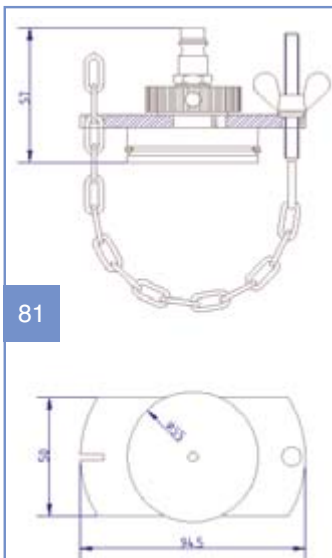

03.9302-0918.2 / 740111

82

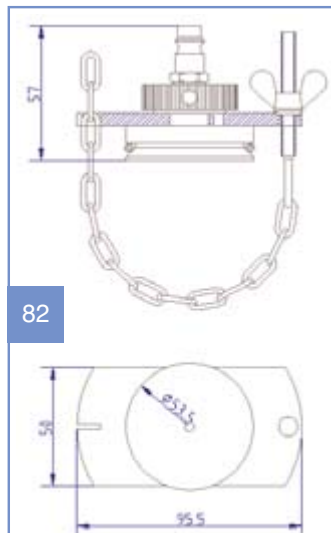

03.9302-0912.2 / 740105

82A

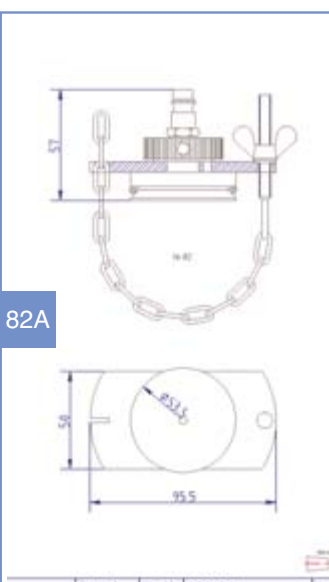

03.9302-0929.2 / 740283

83

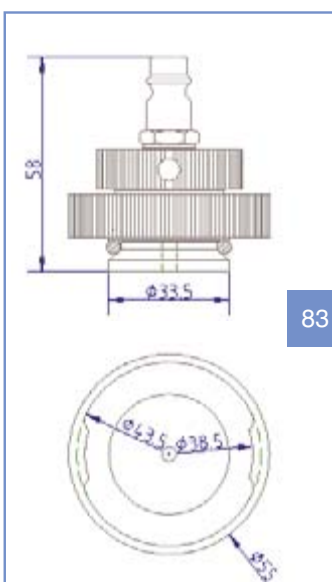

03.9302-0939.2 / 740221

84

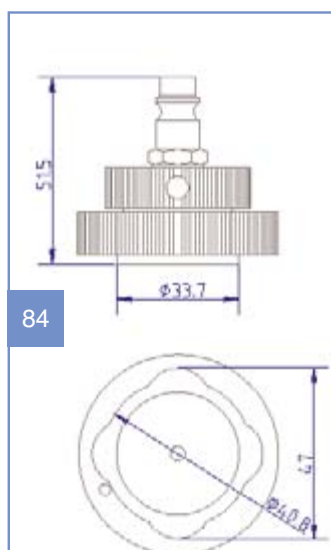

03.9302-0944.2 / 740233

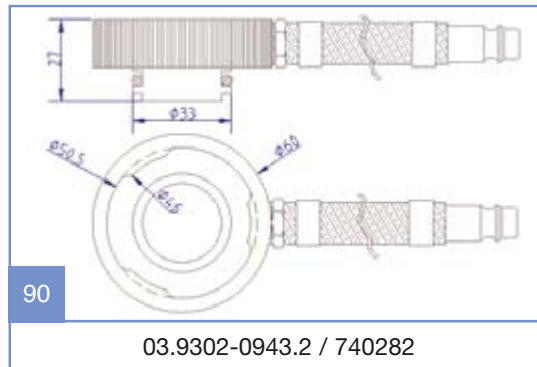
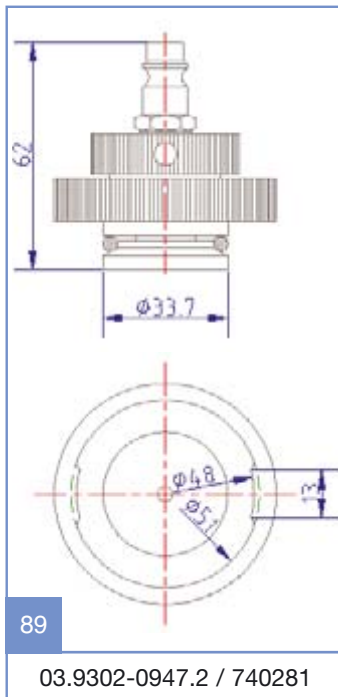
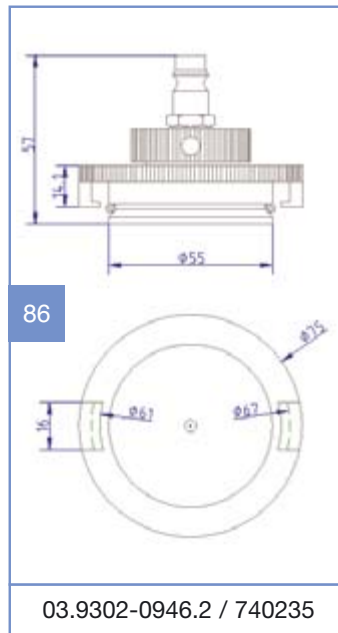
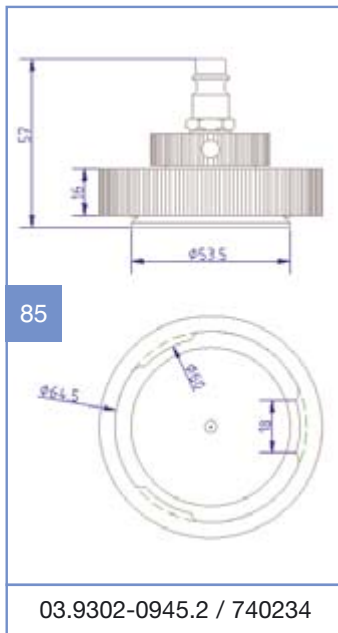



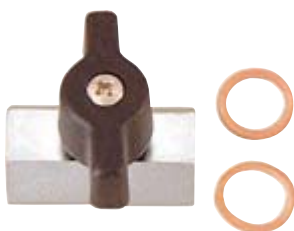

03.9302-9010.3 / 740251

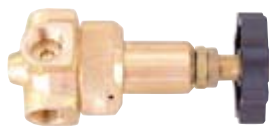

03.9302-9050.3 / 740252



03.9302-9021.3 / 740243



03.9302-9041.2 / 740249



03.9302-9001.3 / 740236



03.9302-9020.3 / 740242



03.9302-9033.1 / 740248



03.9302-1000.4 / 740122



03.9302-9079.3 / 740259



03.9302-9402.3 / 740269

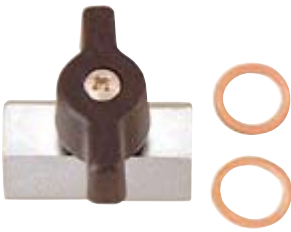

03.9302-9010.3 / 740251



03.9302-9020.3 / 740242



03.9302-9021.3 / 740243



03.9302-9041.2 / 740249



03.9302-9001.3 / 740236

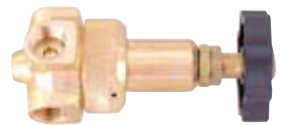

03.9302-9050.3 / 740252



03.9302-9031.1 / 740246



03.9302-1200.4



03.9302-9071.3 / 740258



03.9302-9020.3 / 740242

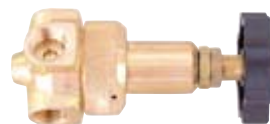

03.9302-9050.3 / 740252



03.9302-9010.3 / 740251



03.9302-9042.2 / 740250



03.9302-9001.3 / 740236



03.9302-1300.4 / 740134



03.9302-9079.3 / 740259



03.9302-9032.1 / 740247



03.9302-9079.3 / 740259



03.9302-9020.3 / 740242

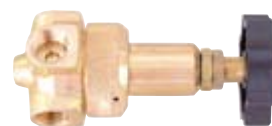

03.9302-9050.3 / 740252



03.9302-9042.2 / 740250



03.9302-9032.1 / 740247

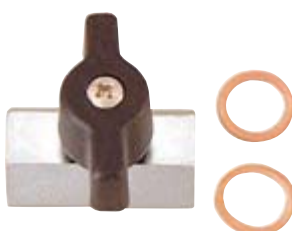

03.9302-9010.3 / 740251



03.9302-1350.4 / 740230



03.9302-9001.3 / 740236



03.9302-9210.2 / 740265

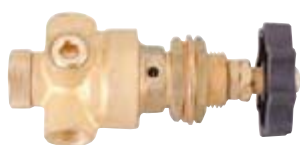

03.9302-9051.3 / 740253



03.9302-9022.2 / 740244



03.9302-9070.3 / 740257



03.9302-1600.4 / 740171



03.9302-9003.3 / 740238



03.9302-9200.2 / 740264



03.9302-9015.3 / 740240



03.9302-9402.3 / 740269



03.9302-9211.3 / 740266



5x20 mm M 2A 250V



03.9302-9022.2 / 740244



03.9302-9250.1 / 740267



03.9302-9200.2 / 740264



03.9302-9052.3 / 740254



03.9302-9070.3 / 740257



03.9302-9402.3 / 740269



03.9302-1650.4 / 740229



03.9302-9003.3 / 740238



03.9302-9211.3 / 740266



5x20 mm M 2A 250V



03.9302-9022.2 / 740244



03.9302-9200.2 / 740264



03.9302-9250.1 / 740267



03.9302-9053.3 / 740255



03.9302-9070.3 / 740257



03.9302-9402.3 / 740269



03.9302-1660.4 / 740231



03.9302-9004.2 / 740239



03.9302-9079.3 / 740259



03.9302-9041.2 / 740249



03.9302-9002.3 / 740237



03.9302-1800.4 / 740197



03.9302-9020.3 / 740242



03.9302-9021.3 / 740243

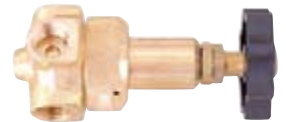

03.9302-9050.3 / 740252



03.9302-9401.3 / 740268



03.9302-9200.2 / 740264



5x20 mm M 6,3 A 250V



03.9302-9250.1 / 740267



03.9302-9023.3 / 740245



03.9302-9211.3 / 740266



03.9302-9060.2 / 740256



03.9302-9101.3 / 740260



03.9302-9052.3 / 740254



03.9302-9102.3 / 740261



03.9302-9019.2 / 740241



03.9302-1900.4 / 740203



03.9302-9003.3 / 740238



03.9302-9401.3 / 740268



03.9302-9200.2 / 740264



5x20 mm M 2/2A 250V



03.9302-9022.2 / 740244



03.9302-9250.1 / 740267



03.9302-9211.3 / 740266



03.9302-9060.2 / 740256



03.9302-9003.3 / 740238



03.9302-9052.3 / 740254



03.9302-9104.3 / 740263



03.9302-9019.2 / 740241



03.9302-2000.4 / 740204



03.9302-9103.3 / 740262



03.9302-9403.3 / 740270



03.9302-9212.3 / 740275



5x20 mm M 5A 250V



03.9302-9022.2 / 740244



03.9302-9250.1 / 740267



03.9302-9200.2 / 740264

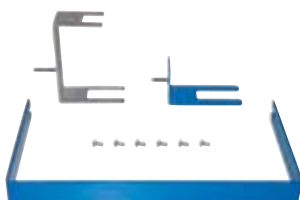

03.9302-9420.3 / 740276



03.9302-9402.3 / 740269



03.9302-3000.4 / 740273



03.9302-9003.3 / 740238



03.9302-9105.3 / 740274

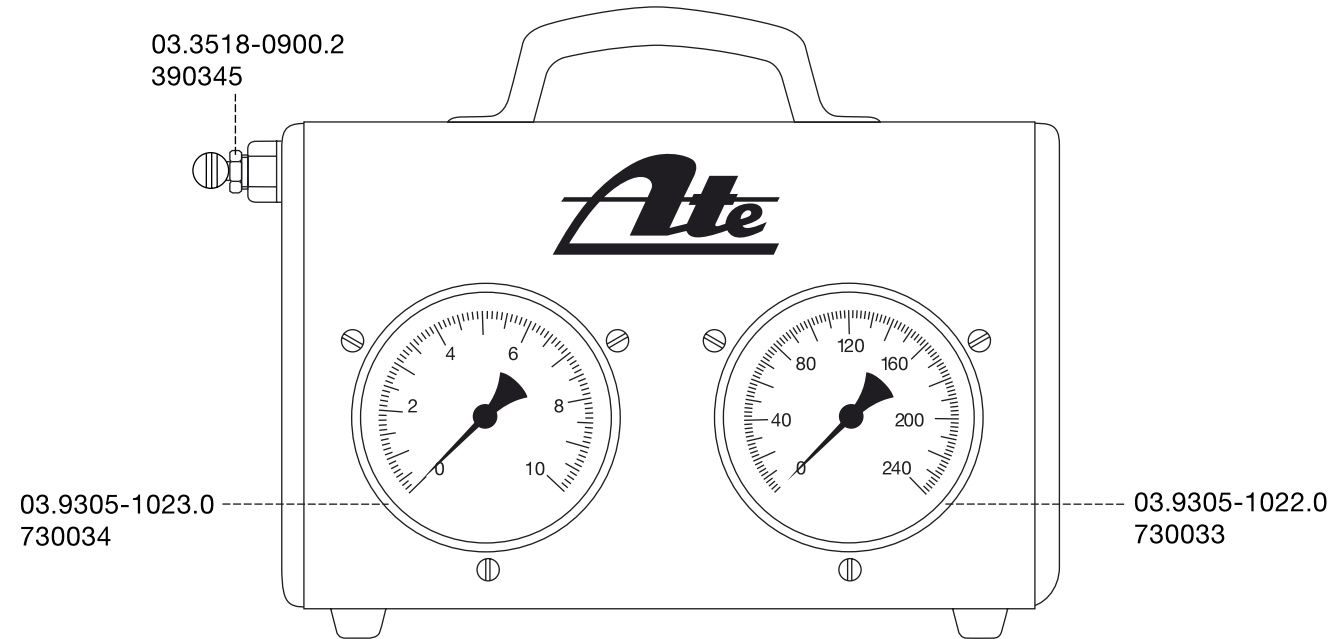

03.9305-0200.4 / 730029

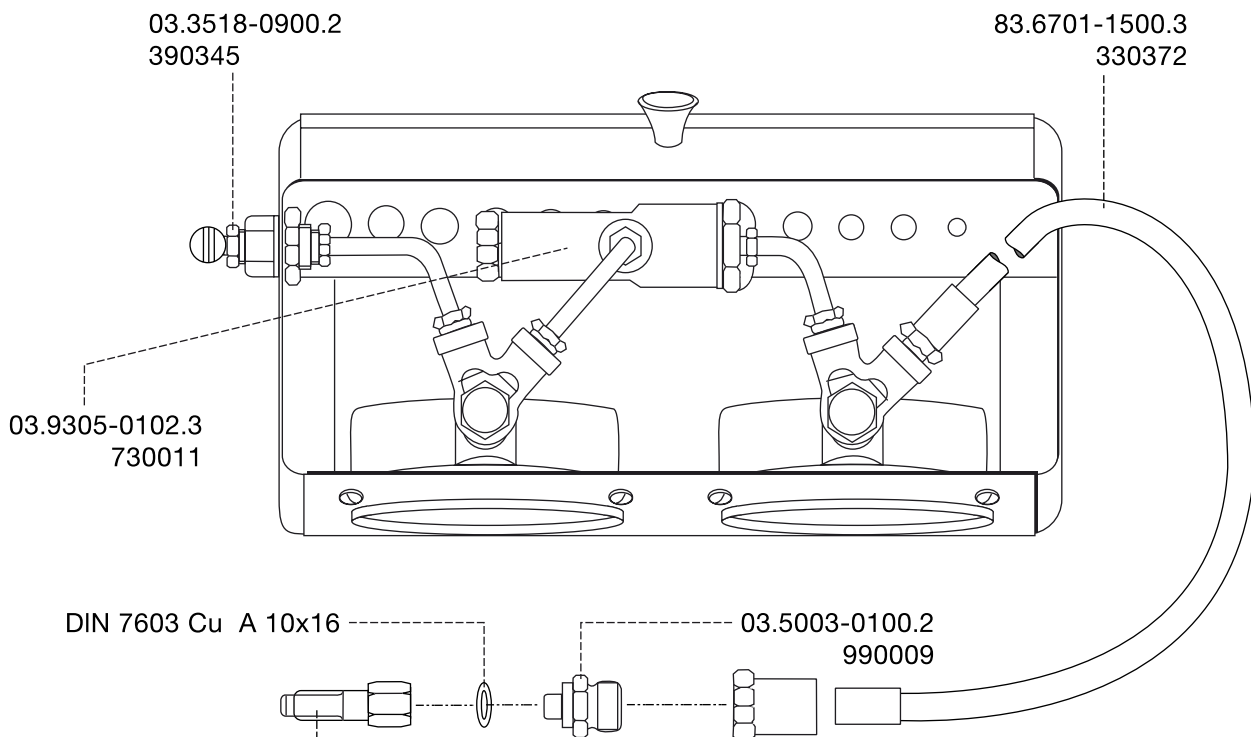

03.9305-0140.2 / 730020

M6	03.9305-0140.1 / 730019
M7	03.9305-0141.1 / 730021
M8	03.9305-0142.1 / 730022
M10 x 1	03.9305-0143.1 / 730023
M10 x 1.25	03.9305-0144.1 / 730024
M12 x 1	03.9305-0145.1 / 730025
M12 x 1.5	03.9305-0146.1 / 730027

1/4"	28 UNF	03.9305-0111.1 / 730012
5/16"	20 UN	03.9305-0120.1 / 730018
5/16"	24 UNF	03.9305-0112.1 / 730013
3/8"	20 UN	03.9305-0119.1 / 730017
3/8"	24 UNF	03.9305-0113.1 / 730014
7/16"	20 UNF	03.9305-0114.1 / 730015
1/2"	20 UNF	03.9305-0115.1 / 730016

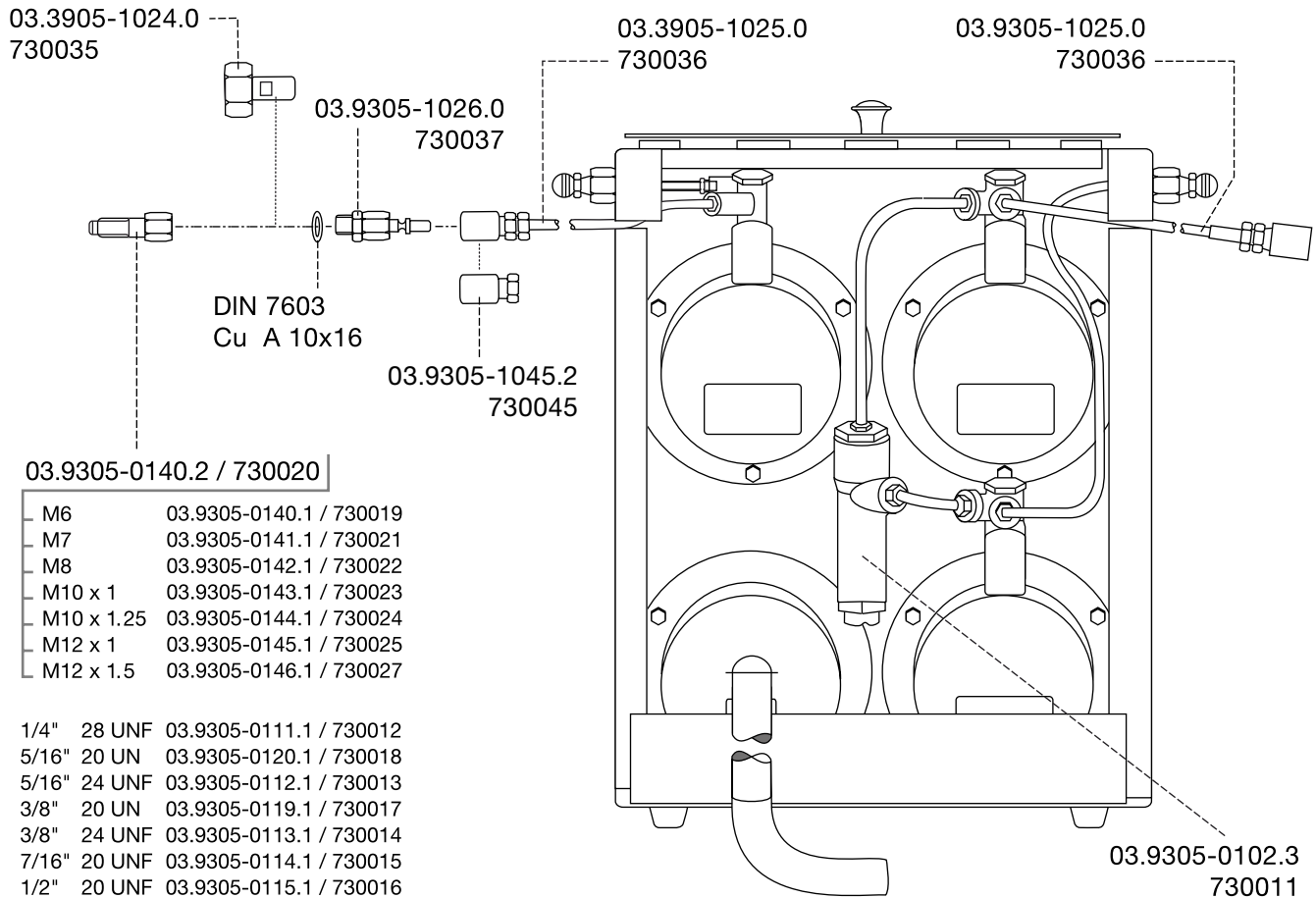
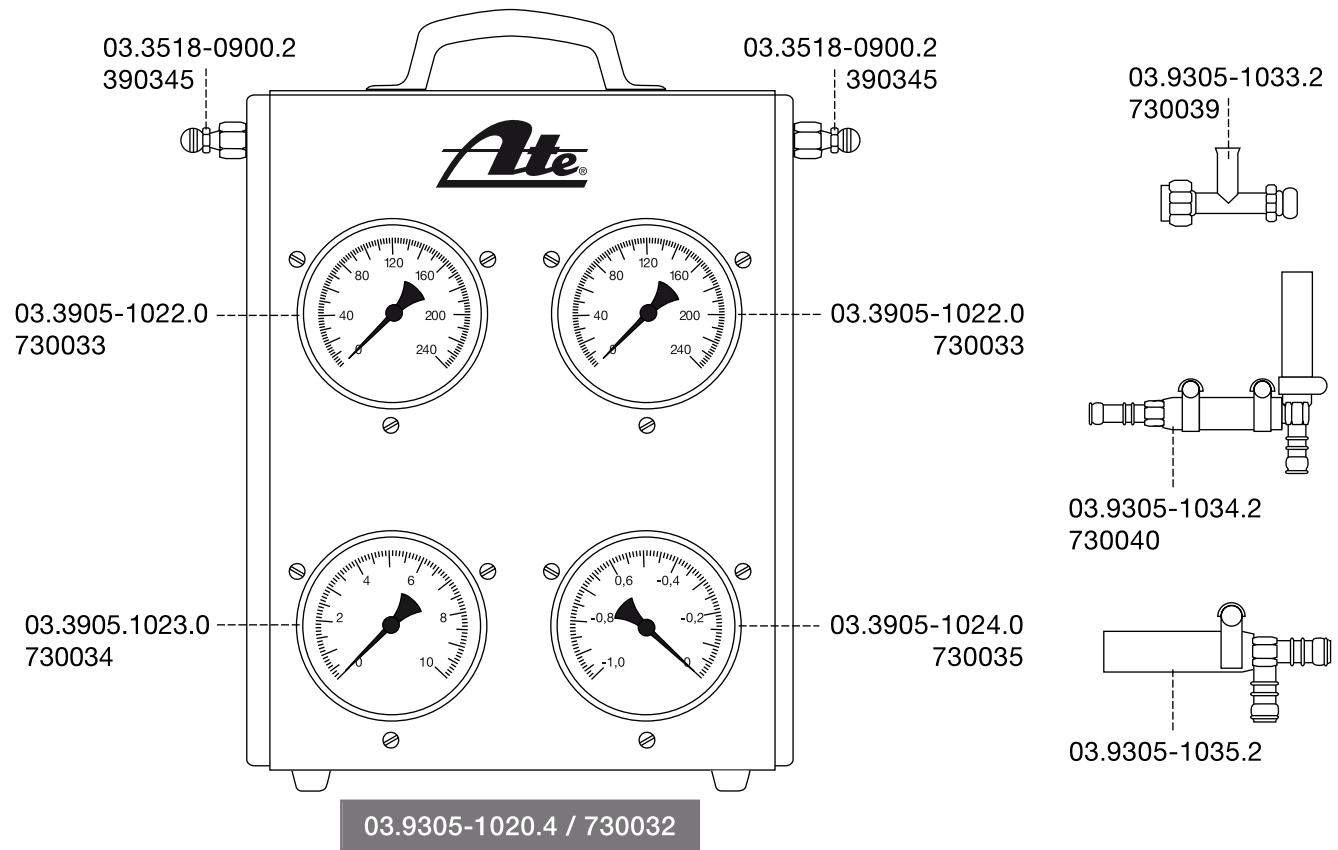



03.9314-4983.1 / 760114	03.9314-4984.1 / 760115	03.9314-4985.1 / 760116	03.9314-4986.1 / 760117
SW 13 Ø 30,6 mm	Ø 47,7 mm	Ø 54 mm	Ø 63,5 mm
03.9314-4987.1 / 760118	03.9314-4988.1 / 760119	03.9314-4989.1 / 760120	03.9314-4990.1 / 760121
Ø 32 mm	Ø 32 mm	Ø 42 mm	Ø 55,5 mm
03.9314-4991.1 / 760122	03.9314-4992.1 / 760123	03.9314-4993.1 / 760124	
Ø 50,8 mm	Ø 30 mm	Ø 32 mm	

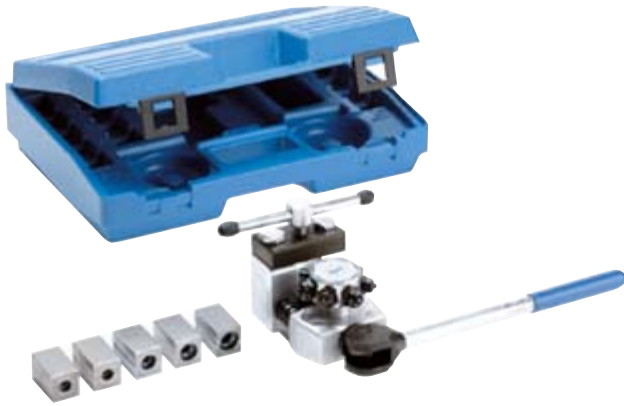

03.9310-0001.4 / 760012



03.9310-0015.4 / 760134

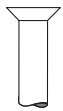

DIN E

Ø			
4,75 mm	03.9310-0010.2 / 760077	03.9310-0005.1 / 760019	03.9310-0006.1 / 760021
6,00 mm	03.9310-0011.2 / 760078	03.9310-0002.1 / 760013	03.9310-0006.1 / 760021
8,00 mm	03.9310-0012.2 / 760079	03.9310-0003.1 / 760015	03.9310-0007.1 / 760022
10,00 mm	03.9310-0013.2 / 760080	03.9310-0004.1 / 760017	03.9310-0007.1 / 760022
3/16" mm	03.9310-0010.2 / 760077	03.9310-0001.1 / 760010	03.9310-0006.1 / 760021

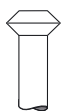

DIN F

Ø		
4,75 mm	03.9310-0010.2 / 760077	03.9310-0005.1 / 760019
6,00 mm	03.9310-0011.2 / 760078	03.9310-0002.1 / 760013
8,00 mm	03.9310-0012.2 / 760079	03.9310-0003.1 / 760015
10,00 mm	03.9310-0013.2 / 760080	03.9310-0004.1 / 760017
3/16" mm	03.9310-0010.2 / 760077	03.9310-0001.1 / 760010

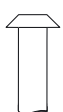

DIN F

Ø		
4,75 mm	03.9310-0014.2 / 760081	03.9310-0005.1 / 760019

Continental Teves AG & Co. oHG
Aftermarket
P.O.Box 9001 20 • D-60441 Frankfurt am Main • Germany
Phone: +49 (0)69 76 03-1 • Fax: +49 (0)69 76 10 61

ATE Hotline
Phone: (+49) 01805 22 12 42 • Fax: +49 (0)69 76 03 3979
Email: ate.hotline@contiautomotive.com

www.ate-brakes.com

